

FOR OFFICIAL USE ONLY

2017-18



**GENERAL MANAGER'S
ANNUAL REPORT
2017-18**



**MODERN COACH FACTORY
RAEBARELI**



LIST OF CHAPTERS

S.No.	Contents	विषय सूची	i' B I ; k
1	Important Statistics	egRo i wkZ vkadMs	1-2
2	General Administration	l keku; lkz' kkl u	3-4
3	Public Relations & Publicity	tu l E idZ vk\$ i pkj ; kfi=d	5-8
4	Mechanical	; kfi=d	9-36
5	Electrical	fo r	37-39
6	Project Department	lkfj ; kst uk	40-45
7	Stores	Hk&lkj	46-52
8	Accounts	y\$kk	53-57
9	Civil Engineering	fl foy bat hf u; fjx	58-64
10	Personnel	dkfed	65-75
11	Medical	fpfdRI k	76-77
12	Vigilance	l rdrk	78-79
13	Security	l g {kk	80-86
14	Sports	[ky&dln	87-89



Annual Report
2017-18

आधुनिक रेल डिब्बा कारखाना, रायबरेली

MODERN COACH FACTORY, RAEBARELI



मैं 31 मार्च 2018 को समाप्त हुए वर्ष के लिए आधुनिक रेल डिब्बा कारखाना, रायबरेली के कार्य की रिपोर्ट अग्रेषित कर रहा हूँ।

I, forward herewith, the report on the working of Modern Coach Factory, Raebareli for the year ending 31st March, 2018.

(राजेश अग्रवाल)
महाप्रबंधक

(Rajesh Agrawal)
General Manager

सचिव
रेलवे बोर्ड,
नई दिल्ली।

The Secretary,
Railway Board,
New Delhi.



Important milestones:

- Foundation stone laid by : Feb' 2007
- Commencement of land acquisition : Aug'2007
- Preparatory construction work commenced : Feb' 2009
- Actual Construction of Factory started :May' 2010
- Commissioning of 33 KV Transmission Line : Jan' 2011
- Finishing & Furnishing shop work completed :April'2011
- First Coach Furnished from shell supplied by RCF/KXH : April'2011
- Furnishing of 1st coach :April'2011
- Furnishing of 1st LWSCZAC(Chair Car) :June' 2012
- Furnishing of 1st LWFCZAC(Ex. Chair Car) : July' 2012
- Dedication of factory to the Nation :Nov' 2012
- Furnishing of 1st LWACCW coach :Nov' 2012
- First Shell Assembly : July' 2013
(Major sub assembly by RCF/KXH)
- Rolling out 100th coach : July' 2013
- Assembly of First LHB coach shell by MCF : July' 2013
- Completion of Bogie shop : Feb' 2014
- Completion of Shell, Paint and Machine shops : Mar' 2014
- Rolling out 200th coach :April'2 014
- Manufacture of first prototype fabricated Fiat bogie :Aug' 2014
- Manufacture of first LHB coach shell by RCF/RBL :Aug' 2014
- Furnishing of 1st LWSCN coach :Sep' 2014
- Completion of Administrative Building : Nov'2014
- Complete Bogie Assembly :Dec' 2014

- Manufacture of first Fiat bogie : Dec' 2014
- Commissioning of 132 KV MRS : Jan'2015
- First Bogie Manufacture : Feb' 2015
- 100th Shell, Manufactured :June'2015
- 1st LSCN Shell, Manufactured :July' 2015
- 100 Bogie Manufactured :Dec' 2015
- RCF, Raebareli Renamed (MCF), Raebareli :Dec' 2015
- 300th LWACCN Coach Furnished :Jan'2016
- Rolling out 500th coach :Feb' 2016
- 1st GS Shell Manufactured :April'2016
- Formed Recognised Technical Training centre :May' 2016
- IMS Certification : Oct' 2016
- 800th Coach furnished :Oct' 2016
- 1st Rake of Humsafar coaches despatched :Nov'2016
- Rolling out 1000th coach : Jan' 2017
- 1st Rake of Antyodaya Coaches despatched :April'2017
- 1st Power Car shell manufactured :May' 2017
- 1000th Shell manufactured :May' 2017
- 5th Rake of Humsafar coaches despatched :June' 2017
- 1st Power Car handed over to ZR : Oct' 2017
- Rolling out 1500th coach : Oct' 2017
- 1st coach of Deen Dayalu despatched : Jan' 2018
- Total 25 nos. Power Car handed over to ZR :Mar' 2018



General Administration



The Team MCF



**Shri Rajesh Agrawal
General Manager**



**Sh. D.K
Agarwal PCME**



**Sh. Harsh Kumar
CAO**



**Sh. A.K. Srivastava
PCEE**



**Sh. A.K. Pandey
PCMM**



**Smt. Renu Sharma
PCPO**



**Sh. Rajesh Agarwal
PCE**



**Sh. Dawa Chhering
FA&CAO**



**Dr. Anil Gupta
PCMO**



**Sh. Inderjit Singh
CDE**



**Sh. Sandeep Shukla
CMM**



**Pranjeev Saxena
CME/IT**



**Sh. R.S.Bhidonia
CEDE**



**Sh. A.K.Jain
CME/P**

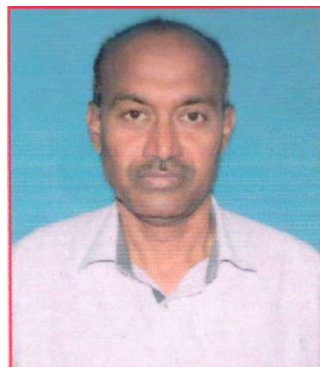

**Sh. R.N. Toppo
CQM**



**Sh. H.K. Raghu
CPM**



**Sh. R.N. Meena
CMM/Fur.**



**Sh. S.k.Rawat
CPLE**



**Sh. B.L. Meena
FA&CAO/P**



**Sh. B. V. Rao
Sr. SC**



**Sh. R.P. Sharma
Secy to GM**



PUBLIC RELATIONS & PUBLICITY

1.1 CELEBRATIONS (DIVAS):-

1.2 Bharat Ratna Dr. B.R. Ambedkar Jayanti

125th Birth Anniversary of Bharat Ratna Dr. B.R. Ambedkar, celebrated on 14.04.2017. On this occasion speakers paid tribute to Dr. Bhim Rao Ambedkar remembering his contribution to the society and the nation.



1.3 Railway Week Award

62nd Railway week was celebrated on 18.04.2017 at Saraswati Auditorium, MCF, Raebareli. Shri M.K.Gupta, General Manager, MCF/RBL was the Chief Guest on the occasion. He presented awards to 11 Officers and 132 employee, besides of group awards to employee for their outstanding services in their respective fields. The function concluded with a colourful cultural programme.



1.4 International Yoga Day

International Yoga Day was celebrated on 21.06.2017 in which a yoga camp was organised in Gomti Indoor Stadium of MCF/RBL where officers, staff and their families participated and practiced Yoga and Pranayam under guidance of a trained yoga instructor as per protocol issued by Ministry of AYUSH.



1.5 World Environment Day

“World Environment Day” was celebrated by MCF/RBL on 05.07.2017. On this occasion trees of different kinds were planted in Workshop and Township premises of MCF/RBL. On this occasion, a lecture of Shri Mohd. Ahsan, Retd. Principal Chief Conservator of Forest & Permanent Member of Wild Life Board, U.P. was organised regarding the issues affecting environment.



1.6 Independence Day

71st Independence Day was celebrated on 15th August 2017 in a befitting manner. National flag was hoisted by Sri. M.K.Gupta, GM/MCF/RBL and parade was displayed in front of Administrative Block. Cultural programme was organised in Sarawati Auditorium.



1.7 Hindi Divas

Vimochan of Second edition of Magazine “Pragati” on Hindi Divas by Sh. M.K. Gupta, GM/MCF/RBL on 14.09.2017 at MCF/RBL Also a meeting was conducted to promote Hindi in day to day work.



1.8 Republic Day

Republic Day was celebrated on 26.01.2018 in MCF/RBL campus with full enthusiasm. Shri Rajesh Agrawal GM/MCF/RBL inspected the parade and took the salute.



2.0 SEMINAR:-

2.1 Vigilance Awareness Week 31.10.17 to 05.11.17

Vigilance Awareness Week : Vigilance Awareness Week is being observed at MCF/RBL from 30.10.2017 to 04.11.2017 as per directives of Railway Board. The main theme of the year's Vigilance Awareness Week was My Vision – Corruption Free India. During the Week various programmes like pledge Take Ceremony, release of 2nd edition of vigilance Bulletin, Quiz on Competition, Vigilance awareness campaign etc. were organised.

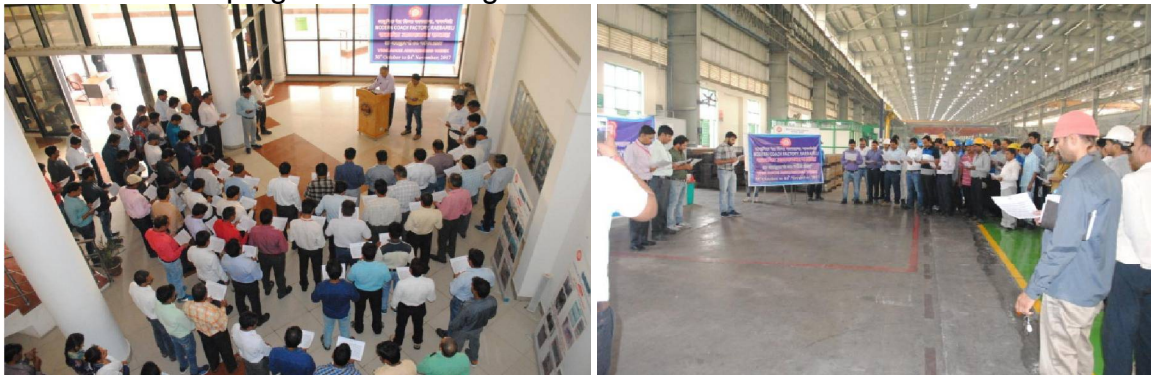

3.0 VISITS:-

3.1 Visit of CCRS and CRSS

Sh. S. Nayak, Chief Commissioner Railway Safety along with 7 CRSSs visited MCF/RBL on 30th August, 2017. They inspected the factory and have appreciated the work done at MCF.



3.2 Visit of MR 22.03.2018

Shri Piyush Goyal/MR/Railway Board visited MCF/RBL on 22.03.18.





Modern Coach Factory, Raebareli

**Annual Report 2017-18
Of
Mechanical Department**

Project Overview and History

Modern Coach Factory (MCF), Raebareli has being set up at a cost of about Rs. 3192 Cr. for producing state of the art, stainless steel coaches (LHB type) manufacturing unit of Indian Railway, with annual capacity of 1000 coaches. This factory covers an area of 540 Ha land, which includes a modern, eco-friendly township with need based social infrastructure for providing limited residential accommodation to employees.

1.0 Exponential growth in production.

YEAR	BOGIE ASSEMBLED AT MCF	SHELLS MANUFACTURED AT MCF/RBL	OUTTURN
2011- 2012	0	0	18
2012- 2013	0	0	70
2013- 2014	0	0	130
2014- 2015	9	45	140
2015- 2016	251	264	285
2016- 2017	631	605	576
2017- 2018	794	876	711

2.0 Design and development:

Following activities in design office have been completed during the year 2017-18 (up to 31st March, 2018):-

2.1 **EOI of World Class Interiors:**

- Expression of Interest (EOI) for Design, Manufacture, Supply, Installation and Commissioning of “World Class Interiors” of Newly Manufactured LHB Design Coaches at MCF opened on 16.01.2018.
- LOA issued to 8 firms and one LWACCN & one LWSCN coach allotted to each firm to complete interior furnishings with World Class Interiors as prototype coach and approval of interiors of the each prototype coach shall be done after evaluation of furnished coaches.

2.2 Stainless Steel Metro Coaches: EOI document for Design, Development, Manufacturing, Testing and Commissioning of **Stainless Steel Metro Coaches** at MCF/RBL has been prepared & floated on website. EOI bid document opening date is 30.05.2018.

2.3 Self-propelled coaches: EOI document for design/engineering, development, manufacturing, testing & final commissioning of bogies for **self-propelled coaches** for train-set with complete propulsion system has been prepared & floated on website. EOI bid document opening date is 28.05.2018.

2.4 LWACCW (EOG) coach with LWACCN roof profile:

Design developed for LHB AC-2T coach using of LHB AC-3T Roof profile. This development resulting 260mm more headroom for upper berths. First Shell manufactured at MCF/RBL and First Coach dispatched on – 02.11.2017.





2.5 **Deendayalu coaches with DGFRP & GFRE panels (45 Nos.):**

- Use of DGFRP panels on side wall panel & partition panel in lieu of LP/HPL sheet.
- Use of GFRE panels for ceiling in lieu of NFTC sheet.



- Cushioned luggage racks which can serve as seat during rush.
- Additional hands hold in doorway area.
- J-hooks near longitudinal luggage racks.
- Vestibuled ends for inter coach movement.
- Water Purifier.
- Bio-toilets.
- Fire extinguishers with anti-theft arrangement.
- More pleasing colour scheme for interior and exteriors with anti-graffiti measures.

Deendayalu coaches with FRP panels & Modular toilets (40 Nos.):

Sidewall & Roof panels : FRP Gel coated Anti graffiti

- Honey comb sandwiched pre-panelled partition frame with FRP sheets on both sides with steel inserts, Gel coated, anti-graffiti.
- Modular toilet: FRP lavatory module, Gel coated Anti graffiti coating
- Bolted Pillar assembly like LWACCN coaches

First Coach dispatched on – 11.01.2018.

Total 85 nos. of coach dispatched in 2017-18.

2.6 **LWSCN (EOG) coach with LWACCN roof profile and wider window & FRP sidewall/roof panelling:**

Design developed to manufacture LWSCN (EOG) coach in LWACCN roof profile with following features:

- i. Wider window.
- ii. FRP side wall panels & FRP ceiling panels.
- iii. Bolted partition frame Honeycomb sandwiched pre-panelled partition frame with LP/HPL sheet on both sides.
- iv. FRP modular toilets.

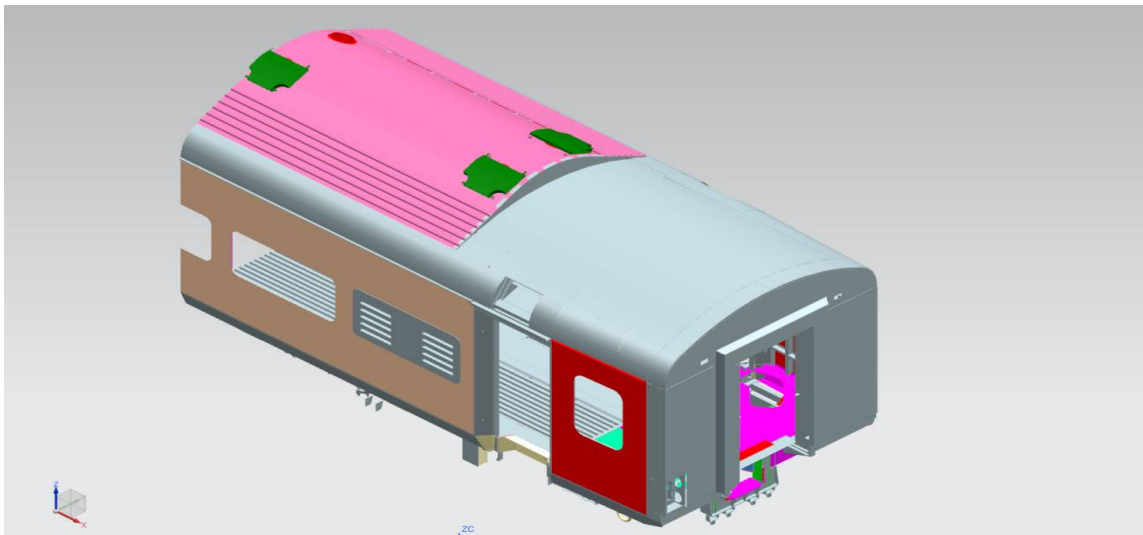
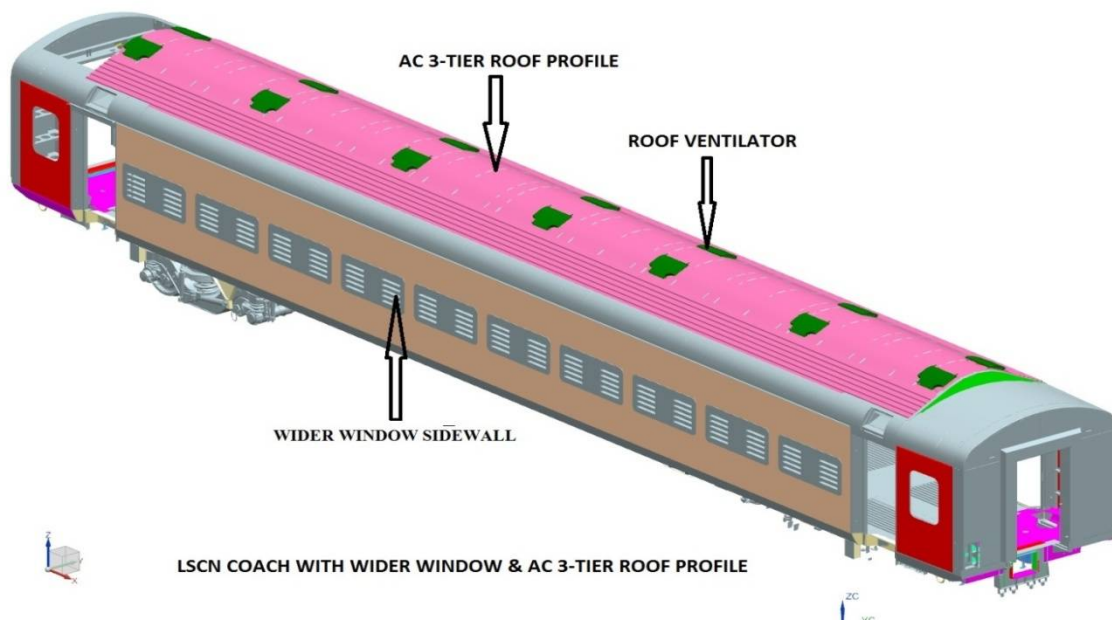

Single Piece Side Lower Berth in Humsafar coaches:

Single piece side lower berth has been introduced in 5th Humsafar rake.

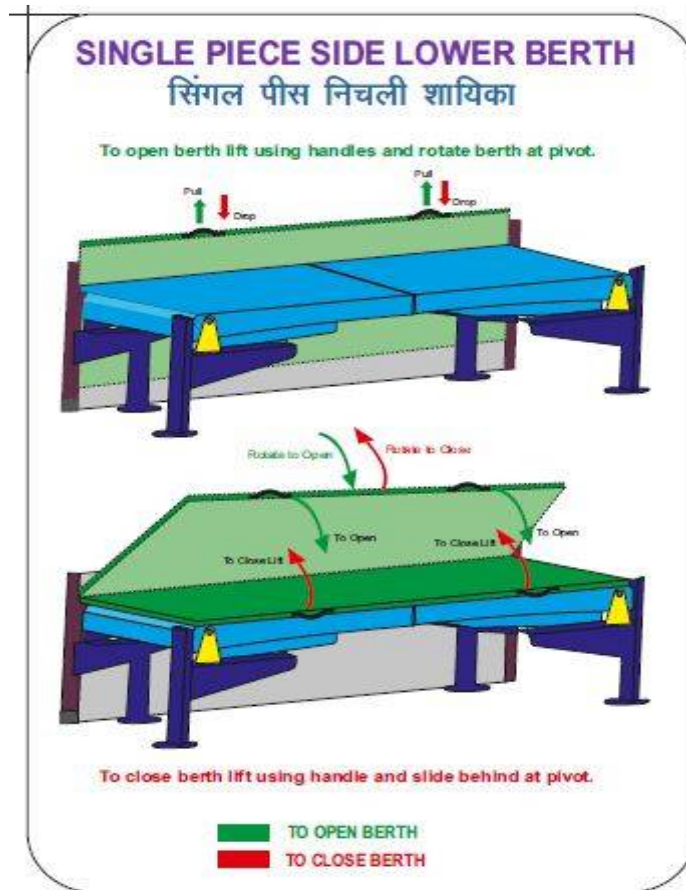

5th Humsafar Rake with Single Piece Side Lower Berth, dispatched on - 11.04.2017.

2.7 Painting:

- Design drawing for new proposed painting scheme (colour: Off white-RAL1013 & Orange RAL-2004) prepared and Trial done on LWACCN & LWSCN coach as mock ups.



- Provision of Safety message on doors.
- Marking diagram for numbering system at body side entrance door & lavatory door to detect problems during running.

2.8 Seats & Berths:

- Design developed for lower luggage rack of Deendayalu Coaches with Corrugated sheet in lieu of Compreg board.
- Design developed for Seats & Berths with 1mm thick corrugated sheet for Deendayalu coaches.
- Introduction of Corrugated sheet (1mm thick) in lieu of Compreg board in Seats & Berths of LWACCW, LWACCN & LWSCN coaches. Modified design implemented in Cushioned luggage racks & seats in Deendayalu coaches.

- Introduction of silicon foam as cushioning material in seat & berth in lieu of PU foam.

2.9 Toilets:

- Introduction of modular toilets in non AC coaches.

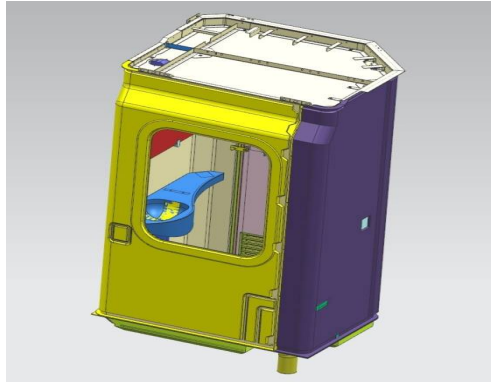

- Introduction of dust bins in the toilets of non AC coaches.

2.10 Design developed for Bio tank arrangement in Track Recording Car and Track Recording Staff Car.

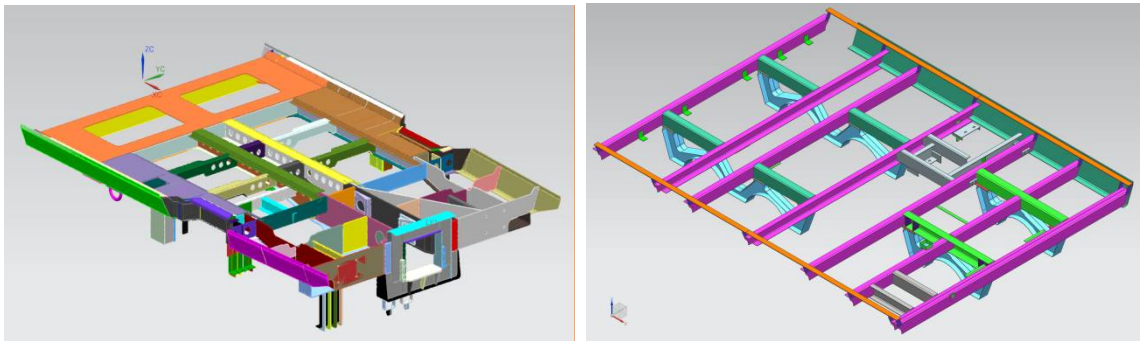

2.11 Design developed for LWSCN coach with wider window.

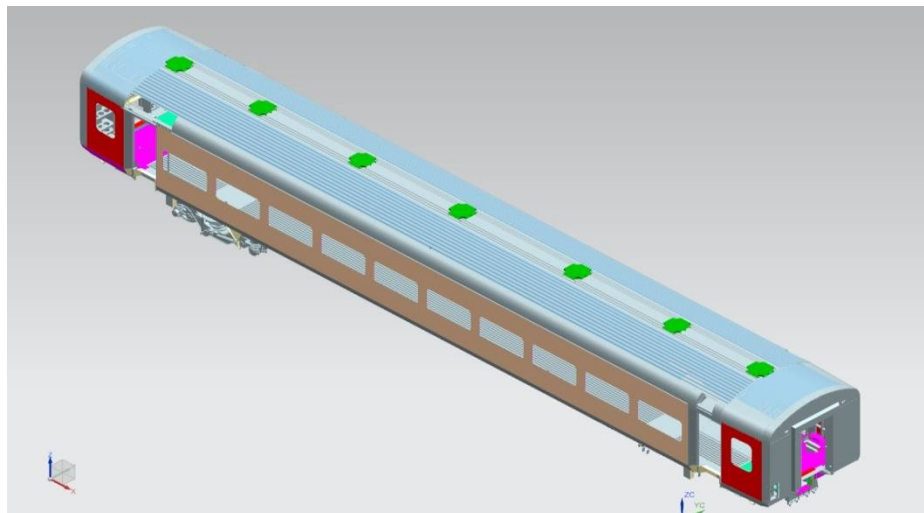

2.12 Introduction of Double ferrule fittings in air brake system.

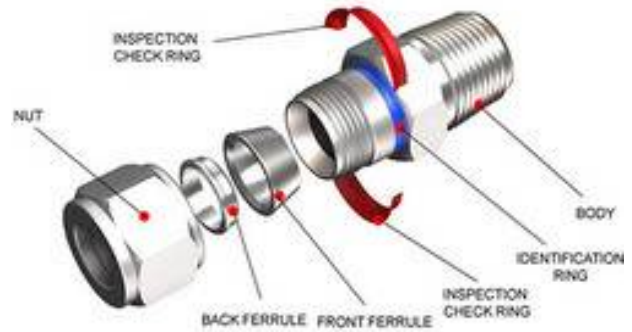

2.13 Pallet design for storage of End walls.

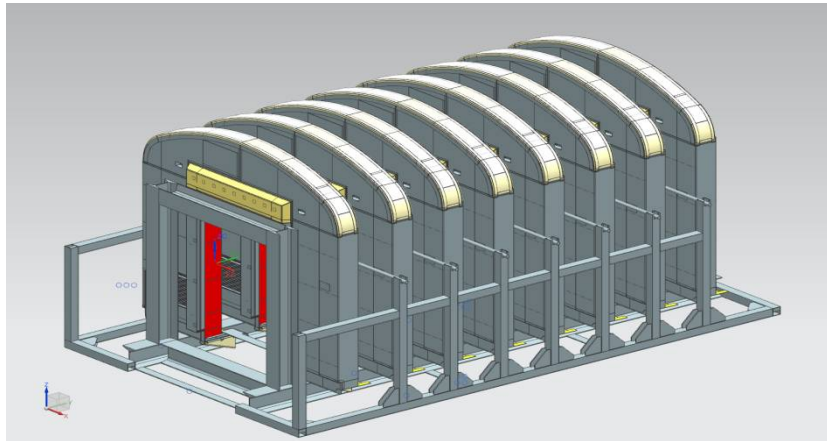

2.14 Pallet design for storage of Carlines.

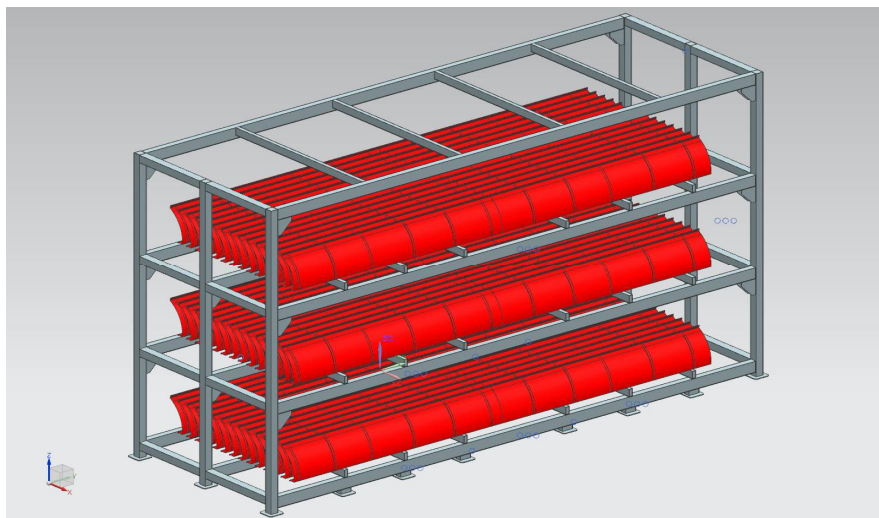

2.15 Layout developed for AC Exec Chair car cum AC chair car composite coach.

3.0 Furnishing shop

3.1 Increase in out-turn: During the year 2017-18 Furnishing shop furnished 711 LHB coaches against 576 coaches furnished in the year 2016-17 which is 23.44% increase in the out-turn. The details of out-turn is as under-

Type of coaches	No. of coaches furnished during 2016-17	No. of coaches furnished during 2017-18	% Increase
LWACCN	94	185	+96.81
LWACCN (Humsafar)	101	89	-11.88
LWACCW	20	34	+70.00
LWSCN	267	231	-13.48
LWS (LS-5)	67	45	-32.84
LWS (Antodaya)	27	17	-37.04
LWS (LSDD)	0	85	+85.00
LWLRRM	0	25	+25.00
TOTAL	576	711	+23.44

3.2 Rolling out of 1st Antodaya rake- 1st rake of Antodaya is gate out on 11.04.2017.

3.3 Rolling out of 1st MCF build Power Car- 1st power car is furnished and dispatched to Zonal Railways on 10.10.2017

3.4 Highest ever gate out in single day- 44 coaches are gate out in single day in the month of February 2018.

3.5 Highest ever gate out in the month-125 coaches are gate out during month of March 2018.

3.6 Coaches furnished for Humsafar and Deendayalu rakes- 04 Humsafar rakes and 85 Deendayalu coaches (fitted with the cushioned seat on transverse luggage rake) is gate out for the year 2017-18.

3.7 Innovations carried out (general):-

- I. Lavatory no. 2 of LWACCN 610 (ECoR-17104/C) and Lavatory no. 1 of LWSCN 410 (WCR-17212/C) were furnished with DGFRP panels and dispatched to the concerned railway on 05.08.2017 and 22.08.2017 respectively.
- II. 50 coaches are turned out with the S-Trap fitted bio tanks in financial year 2017-18.
- III. One LWSCN coach (Railway No.173343/NR) fitted with Heat detection system is dispatched to Northern Railway on 26.12.2017.

3.8 Production target for the year 2017-18:- Surpassing the target of 710 coaches, 711 coaches are furnished & gate out for the financial year 2017-18.

4.0 Bogie Shop & Wheel Shop

4.1 Important milestone for Bogie shop:

- Completion of bogie shop– Feb-14
- Manufacturing of first prototype fabricated FIAT bogie– Aug-14
- Manufacturing of first FIAT Bogie– Dec-14
- IMS certification– Oct-16
- 5S certification– Nov-17
- 100th Bogie manufactured– Dec-15
- 1st LS5 Bogie manufactured– Jan-17
- 1st power car bogie manufactured– May-17

4.2 Production Statistics of Bogie Shop

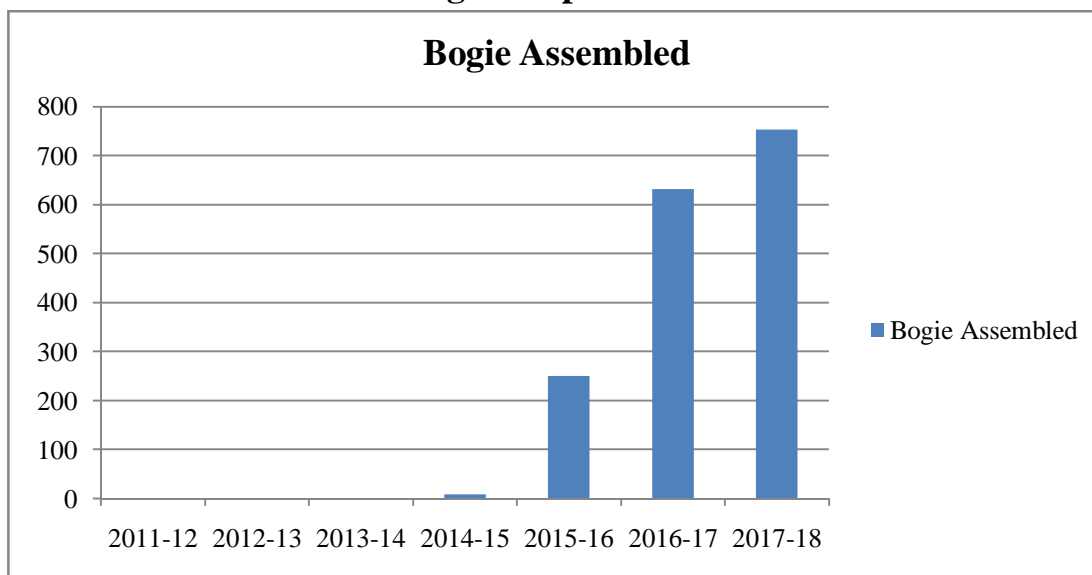

Type wise production of Bogie shop are as given below:

LWACCW	LWACCN	LWLRRM	LWSCN	LSASP	TOTAL
44	304	28	228	149	753

4.4 Production details of various section of Bogie and Wheel Shop:

S.No.	Section		Target	Achievement	Remarks
			In C/set		
1	CNC Under Water Plasma Machine	Bogie Frame	250	326	30.4%
		Bolster	350	310	-11.4%
2	CNC Edge Milling Machine	Bogie Frame	250	308	23.2%
		Bolster	350	411	17.4%
3	Bogie Fabrication Line	Bogie Frame	250	310	24%
		Bolster	350	419	19.7%
4	Bogie Paint Line	Bogie Frame	250	317	26.8%
		Bolster	350	415.5	18.7%
5	CNC Bogie Frame Machining Centre	Bogie frame	250	292.5	17%
6	CNC Bolster Machining Centre	Bolster	350	414	18.2%
7	Bogie Assembly	Bogie	710	753	6.05%
8	Wheel Shop	Wheel set	710	829.25	16.7%

4.5 Innovation throughout the FY 2017-18.

4.6 Modification in Machining Fixture for LS-5 Bolster



Modern Coach Factory
Raebareli

MODIFICATION IN MACHINING FIXTURE FOR LS-5 BOLSTER

**FIXTURE FOR MACHINING OF
2T/3T/LSCN TYPE BOLSTER AS PER
DRG NO 1267420-04R**



**MODIFIED FIXTURE FOR MACHINING
OF LS 5 TYPE BOLSTER AS PER
DRG NO LW 04001**



- 1. BOLSTER LOCATER HUB CHANGED.**
- 2. BOLSTER CLAMPING STUDS CHANGED.**
- 3. BOLSTER CLAMPING BOLTS CHANGED.**
- 4. BOLSTER MACHINING REFERNCE POINT PLATE CHANGED.**

4.7 Requirement of modification

Fixture supplied with CNC Bolster machining center was not suitable for fitment of LS-5 type bolster machining so there is requirement of special type fixture for machining of LS-5 type bolster as per Drg.No.LW04001.

4.8 Efforts made in line for the Innovation

- Old extra idle fixture available in Bogie shop is used for modification.
- After modification this fixture can be used for machining of LS-5 type bolster (as per Drg.No.LW04001) 1 C/s in a shift.
- With this fixture 280 Nos. (140C/s) LS-5 type Bolster are machined till now.

ADVANTAGES:-

- The total cost of the innovation came out to be Rs.1.90 Lakh which is 1/8 of the total cost of new Bolster machining fixture i.e. Rs.15.13 Lakh (Approx.)
- The old extra idle fixture was efficiently used.
- After modification the machining of LS-5 type Bolster as per Drg. No.LW04001 made possible so that manufacturing of LHB bogie with air spring secondary suspension has possible which is used in LGS, LWS, DG, DF Deendayalu LHB coaches.

4.9 Bogie Frame Touchup Station



4.10 Efforts made in line for the innovation:-

- Two idle side pillar assembly of the manipulator were brought from the shell shop
- Centre beam was manufactured which was then mounted on turning disc on both side.
- Bogie frame loading fixture was manufactured which can be rotated 360⁰.
- Gear box & motors which were already installed in the side pillar assembly were duly serviced & made ready.
- Electrical wiring interlocking and synchronisation was done.
- The working platform was also manufactured.
- The primer was applied on the complete bogie frame touch up station assembly and then double coating was done.
- Since then the repeated trails have been carried out in the bogie frame touch up station marking the successful completion of the innovation.

Advantages:

- The total cost of the innovation came out to be Rs. 3.95 lakh which is approx 1/6 of the total cost new bogie frame touch up station i.e. 24 lakhs.
- The idle lying side pillar assembly was efficiently used.
- The productivity of the bogie frame fabrication will be proportionally increased i.e. doubled.

4.11 **Tool and insert change for Re centring and chamfering operation at CNC End Facing Machine (OP-10) of Wheel Shop:**

Old insert of Kennametal

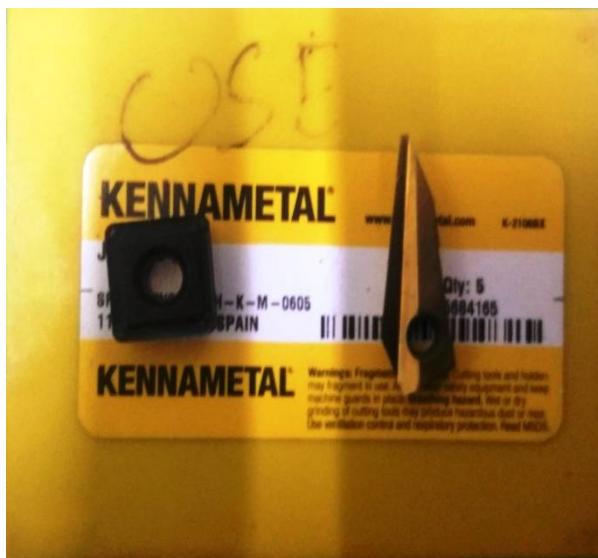

New insert and tool of Sandvik



Comparative saving after tool changing from M/s Kennametal to M/s Sandvik are as given below:-

M/s Kennametal:-

- Required insert for Recentring operation :- 04 nos for 15 Axle
- Required insert for Chamfering operation :- 02 nos for 60 Axle
- Rate of Recentring insert :- Rs.12498/piece
- Rate of Chamfering insert:- Rs.1335/Piece
- Cost of Recentring operation for one axle:- Rs. $12498*4/15= 3333/-$
- Cost of Chamfering operation for one axle:- Rs. $1335*2/60 = 45/-$
- **Total cost for above operation One Axle:- Rs. $3333+45 = 3378/-$**

M/s Sandvik

- Required insert for Roughing recentring operation :- 06 nos for 80 Axle
- Required tool for finishing recentring & chamfering operation :- 02 nos for 200 Axle
- Rate of Roughing re centring insert:- Rs. 1600/-
- Rate of finishing re centring & chamfering tool:- Rs. 60000/-
- Cost of Roughing re centring operation for one axle :- Rs $1600*6/80= 120/-$
- Cost of Finishing re centring & chamfering operation for one axle:- Rs. $60000*2/200=600/-$
- **Total cost for above operation in One Axle:- Rs. $120+600= 720/-$**
Net savings for one axle by changing of insert/ Tool: - Rs. $3378-720= 2658/-$

Advantages:-

- **The total cost savings after change came out Rs. 88.13 lakh in the financial year 2017-18.**
- **Fitment of tool & insert fitting easier than previous.**

4.12 Assembly of 1st Power Car Bogie



LWACCN BOGIE



LWLRRM BOGIE

FEATURES OF POWER CAR (LWRRM)BOGIE

1. Bogie Frame & Bolster are similar as normal Fiat Bogie except following differences-

1.1 The following components are fitted also.

S.No.	Description of the Sub-Assembly/ Component	Drawing No. of Sub Assembly/ Component
1	Hand Brake Support	1267798
2	Support	1277372
3	Stiffener	1277367
4	Stiffener	1277368

2. Spring arrangement is also different.

3. Brake ratio has changed from 1:2.17 to 1:2.48.

Efforts made for the 1st in-house production of 1st power car Bogie

- Fixture manufactured for hand brake support Drawing No.1267798.
- Fixture manufactured for support Drawing No.1277372.
- Jig manufactured for hand brake support Drawing No.1267798.
- Jig manufactured for support Drawing No.1277372.
- Jig manufactured for Stiffener Drawing No1277367.
- Jig manufactured for Stiffener Drawing. No.1277368.

Advantages

- The cost of the modification is Rs1,73,250 .00
- It results in fabrication and assembly of 1st power car bogie.
- By this modification Bogie Shop is in condition to arrest trade failure of supply of power car Bogie frame.

4.13 Bogie Shop Machines Availability

S N	Description	Qty.	Commissioning & proving out date	Warranty completion date	Availability in %	Remarks
1	Hydraulic press 50T*	1	17.09.15	<u>16.09.17</u>	96.8	
2	Bogie load testing machine M/s hydropack, Belgaum	2	IRCON challan no. 323-325 & 145 dtd 10.02.14	<u>09.02.16</u>	(i) 97 (ii) 97.5	

3	CNC Oxy Acetylene (Bogie M/s pro-Arc welding and cutting, pune)	1	Joint note- 14.02.14	<u>13.02.16</u>	97.4	PTC was delayed due to some documents were pending from firm end to be submitted, after commissioning & prove out on 14.02.14
4	CNC UNDER WATER PLASMA profile cutting machine with bevel cutting head (Bogie M/s Soitab, italy)	2	Joint check- 28.03.14 16.04.14 (F)	<u>15.04.16</u>	(i)71.8 (ii)88.4	PTC delayed due to some document form firm was pending. However the machine was handed over for production work after commissioning & prove out
5	Plate Straightening Machine (bogie M/s Godrej' Mumbai)	1	Joint Note- 29.01.14 challnan no. 140 to 142 dtd 29.01.14	<u>28.01.16</u>	95.1	
6	CNC Edge milling Machine (bogie, M/s Swastik)	1	21.07.14	<u>20.07.16</u>	73.1	The m/c was commissioned and handed over to MCF for production work on 21.07.14 after completing all the Milling operation except cycle time achievement for component as per the PO. The firm kept on attending the minor/major breakdown form 21.07.14 cycle time for component was achieved on 20.05.15 and till then the m/c was used for approx 600

						hrs. Hence in this particular case, since the m/c was being used for production work with due response of firm for any breakdown as & when required, the warranty is to be considered from 21.07.15
7	Bolster Machine centre (Bogie m/s Tos Kurim, czech Republic M/s Swastik)	2	19.12.14 (1st)08.01.15(2nd)	<u>18.12.16(1st)07.01.17(2nd)</u>	(i)93.4 (ii)75.5	The m/c was handed over for the production work with some pending issues like docs & training etc.
8	5- axis CNC press barke 650T (bogie m/s , Baykal, turkey),M /s machine tool (I) Ltd	1	26.05.14	<u>25.05.16</u>	100	
9	Bogie frame and Bogie bolster Shot blasting and painting line (m/s Global Engineers Ltd. New Delhi	1	06.04.15	<u>05.04.17</u>	54.9	
10	Airless Short blasting machine for steel plates (M/s surface International Jodhpur, Bogie)	1	joint Note- 14.03.14- 02.05.14 (f)	<u>01.05.16</u>	99.6	
11	Introduction heating machine (M/s unites Instrument, Thane, Bogie	1	21.06.14	<u>20.06.16</u>	97.3	

1 2	Bogie frame machine centre *(M/s SNK, japan, Bogie	2	18.03.15	<u>17.03.17</u>	(i)87.1 (ii)95.13	After Commissioning the m/c had to produce 24 nos. job and after that 01 month observation period as per PO terms.
1 3	CNC Bed milling machine (M/S Tos Kurim, CZ Republic, M/S Swastik, Bogie	1	19.12.14	<u>18.12.16</u>	83.9	The m/c was handed over with some pending points(like matching of spares certificates sequence operation etc.
1 4	Bogie Fabrication Line	1				Rejected

4.14 Wheel & axel assembly Line Supplier:- M/s Danobat Group, Spain

Installation Date: - 08.04.2015

Wheel & axel assembly Line Commissioning Date:-17.10.2015

PTC Date:-27.02.2017

Position of Machines Installed in Wheel Shop FY 2017-18

S. No.	Machine Name	Average Availability in %
1	OP 10 (End Facing Machine)	98.6
2	OP 20 (CNC Axle turning Lathe)	71.07
3	OP 30 (CNC Grinding Machine)	92.4
4	OP 60 (Axle Washing & Drying Machine)	99.6
5	OP 70 (Axle Measuring machine)	90.3
6	OP 100 (VTL)	98.6
7	OP 200 (Hydraulic Press machine)	99.5
8	OP210 (Surface Portal Lathe)	99.2
9	OP 220 (Wheel balancing Machine)	100
10	OP 300 (wheel & Axle Line gantry)	97.1

Performance of Tool Room for FY 2017-18 are as given below.

5.0 Shell component:-

S.No.	Name of component	Target in C/set	Achievement in C/set	Remarks
1	Fixing Channel	275	275	
2	Bracket (LG 14169)	299	299	
3	Plate (8x40x40)	240	240	
4	Plate (8x150x310)	133	133	
5	Plate (8x50x109)	155	155	
6	Plate (8x80x109)	71	71	
7	Plate (8x150x226)	98	98	
8	Plate (8x40x63)	397	397	
9	Bracket (LG 16163)	20	20	
10	Bracket (LG 14167)	4	4	
11	Bracket (LG 14168)	1	1	
12	Bracket (LG 16188)	13	13	
13	Bracket (LG 16142)	28	28	
14	Bracket (LG 16127)	7	7	
15	Stud Plate(8x40x130)	52	52	
16	Corner sheet(1000085)	17	17	

5.1 Furnishing component:-

S.No.	Name of component	Target in C/set	Achievement in C/set	Remarks
1	Aluminium extrusion	48	48	

5.2 Bogie component:-

S.No.	Name of component	Target in C/set	Achievement in C/set	Remarks
1	Upper Box	138	138	
2	Bracket 32mm	231	231	
3	Screwing Block	94	94	
4	Stiffener	220	220	
5	Core Bore ϕ 40.0mm	15	15	
6	Screwing Piece	138	138	
7	LUG ET-11151	6	6	
8	EYE LW-01439	35	35	
9	Tube Big 1267703	12	12	

5.3 Innovation throughout the year:

Modification of Fixture and CNC Programming for machining of Control Arm at CNC DMG Milling Machine.



CONTROL ARM LOWER RIGHT FIXTURE

Requirement of modification

Fixture for machining of lower right control arm, supplied with CNC DMG milling machine was not suitable for machining of lower right control arm and was incomplete. Therefore for machining of control arm it is necessary to modify the fixture and CNC programming for the machine.

Efforts made in line for the Innovation

- Existing fixture was modified for machining of lower right control arm.
- Necessary CNC programming was modified for machining and prove out of control arm.

ADVANTAGES:-

- The total cost of the innovation came out to be Rs.1.25 Lakh.
- DMG Milling machine is in running condition and is in continuous use of machining of control arm set.

5.4 Good work done:-

1. Repair of bending blade of sheet folding machine in SMS.
2. Bolster stage-1 & 2 jig rectification work done in Bogie shop.
3. Control Arm machined - 35 C/set (280 nos.)
4. Bolster stage-1 fixture repair have been carried out.
5. Centre pivot locator has been repaired for Bolster stage -2 of Bogie Shop.
6. Re sharpening of drill bits $\phi 5.0\text{mm}$, $\phi 8.0\text{mm}$, $\phi 10.2\text{mm}$ & $\phi 14.0\text{mm}$ and End mill cutters $\phi 25.0\text{ mm}$.
7. Modification and repairing of Bogie bolster stage 1 &2 locator.
8. Calibration of 528 measuring instruments of MCF have been completed in February 2018.

6.0 Shell Shop

6.1 Performance of Shell Shop (2017-18).

S.No.	Activity	Target in C/S	Achievement in C/S	% Improvement
1.	Sidewall skin produced on LCWM	710	824	16.05
2.	Side wall produced	710	830	16.90
3.	Roof Produced	250	363	45.2
4.	Under Frame Produced	250	276	10.4
5.	Shell Assembly Produced	710	751	5.77

6.2 Best Ever Figure in a Month

S.No.	Activity	Achieved in C/S	Month/Year
1.	Sidewall skin produced on LCWM	79	Feb' 18
2.	Side wall produced	90	Mar' 18
3.	Roof Produced	46	Aug' 17
4.	Under Frame Produced	30	Jan' 18
5.	Shell Assembly Produced	81	Oct' 17

6.3 Major critical Items during the FY 2017-18.

S.No.	Description	PI No.
-------	-------------	--------

1.	Set of Roof Element	33690790
2.	Centre Buffer Coupler	33554511
3.	Set of Door Cut Out	33565247
4.	Integrated WTCC	33556210
5.	Under Frame for LSCN, LGS, LWACCN	
6.	Roof Complete for LSCN, LGS, LWACCN	

6.4 Innovative work in the year 2017.

- 03 nos of Undulations free shells (LGS-38, LSCN-78, L3T-54) produced during the month. By improving the handling and counselling of staff. Now the shells are produced having minimum undulation.
- A hydraulic trolley procured and modified as per requirement and used successfully for CBC fitment from under slung. Total 100 coaches CBC fitted in assembled shells.
- New Coach variants produced in the Year are LWLRRM, TRC observation car & TRC staff Car.
- First 3T side wall with 2.5 mm thick skin successfully produced with minimised undulation.
- Roof flange shifted from Laser cutting machine to drill machine saving the Laser profile cutting of LCM machine. This enhanced the production ration of the LCM.
- Shell shop has obtained 5-S certification.
- Brazing on sealing angle started in place of Mig. welding and also Brazing in Place of Mig tacking on Framing stage of Side wall has been implemented.
- Multi Station Machine shifted from TOOL ROOM to SMS, this resulted in saving of manpower and unwanted material handling.
- Items like sole bar, roof flange, roof sheet, connecting sheet, Roof Bearer procured in CRF form and successfully used in production.
- Modular type of clamping and locking arrangement has been successfully modified and implemented on Side wall framing Jig for LSCN side wall. This has improved the quality of Side Wall.

7.0 Quality

7.1 Furnishing Quality Control:

No. Of Coaches inspected	Audit inspection	Bio Tank Testing	RSC Uploaded
729	311	729	666

7.2 Activities of furnishing quality control:

- Coaches furnished at furnishing & finishing shops are inspected at stages of Floor & PVC, Window & Ceiling, Partition & Panelling, Moulding & Door, Plumbing, Lavatory and Seat & Berths with self Inspection (SIP), Quality Control Inspection (QCI), Cross examination (X-Point) and final inspection for ensuring complete quality of product.
- RSC (Rolling Stock Certificate) prepared and uploaded at MCF website for easy and early availability to concerned Railway.
- 05 Rakes of Humsafar (102 Coaches) inspected for quality of additional fitting.
- 01 rake of Antyodaya (22 Coaches) inspected.
- DEENDAYALU 85 COACHES inspected

7.3 Bogie Quality Control:

No. of Bogie Frame and components measured on 3D-CMM	Audit inspection of Bogie components	Audit inspection of Bogie assembly load testing
50+55+501=606	101	843

7.4 Activities of Bogie Quality Control:

- Bogie fabricated at Bogie assembly inspected thoroughly in accordance with SIP (self inspection) submitted by production.
- Screws are checked for proper Torque and Air brake fitting are also checked.
- Bogie final assembly is inspected for load testing.

7.5 Activities of Wheel Quality Control:

- Machining of Axle and Wheel and their fitment is observed at all stage of wheel & Axle line.

- QC has advised to adjust the roughness value of axle sitting area in grinding machine for better interference fitting. This resulted in no use of emery paper for getting roughness, saving of time & man-hours along with improve work culture. Similarly in turret lathe machining operation also adjusted to improve the wheel bore roughness for better interference.

7.6 Shell Quality Control:

No. Of Assemblies inspected	Audit inspection of Assembly shell components	Integrated SIS shell line components inspected	
727	498	Shell	01
		Roof	nil
		Under frame	59
		End Wall	07
		Side Wall	nil
		Total	67

7.7 Activities of shell Quality Control:

- Integrated SIS shell line components measured for commissioning.
- All shell assembly are inspected according to SIP, quality control inspection (QCI), Cross examination (X-Point) and final inspection for ensuring complete quality of product.
- Audit inspections of Shop made and bought out items are carried out.

7.8 Activities of Coach Complaint and monitoring cell (CCMC)

- Coach complaint portal at MCF site is checked daily and complaint if any received in portal is put-up for further action. Monitoring of warranty claim compliance accordingly.

Cases of failure reported by Railway	Mechanical	Electrical	Total
Cased received	126	51	177
Case closed with finalization of warranty claim.	90	22	112

7.9 Activities of CCMC:

Other activities of Quality Control:

Section	Approval of QAP	Approval of prototype
Shell	46	21
Bogie	23	13
Furnishing	08	09
Total	77	43

8.0 M&C Lab and RI wing

- M&C lab has conducted testing of 670 consignments offered for inspection from stores.
- M&C lab is fully involved in stage wise inspection of painting of coaches and quality clearance w.r.t painting.
- MPI of axles in wheel and axle shop was conducted during machining of axles and audit check of axles by UST on periodic basis.
- Installation and commissioning of 10 lab equipments were done in M&C lab
- Chemical analysis of about 1400 samples was done by handheld spectrometer and optical emission spectrometer lab model under procurement stage.
- Inspection of humsafar w.r.t vinyl wrapping was done and inspection of Deendayalu coaches with anti graffiti coating was done.
- DP test conducted in shell shop.
- 68 cases of non conformity raised by shop floor were cleared.

9.0 Planning

- Planning for material, manpower etc. is done by planning section according to target received from Railway Board for production of various types of coaches. After correction in MMIS on the basis of PSL and preparation of indents and material schedules with vetting by account

department, material availability has been ensured through store department for the year 2017-18. Stocking proposals have been made for stocking of non stock items required regularly which were purchased through non stock indents.

- Stocking have been done for approx 35 high value non-stock items used in all types LHB coaches.
- Materials planning of 100 nos. Humsafar and 196 nos. Deendayalu coaches on turnkey basis have been done for year 2017-18 and 200 nos. Humsafar and 87 nos. Deendayalu coaches for 2018-19.
- For controlling the no. of inventories, detail items for Underframe, RMB items, Dampers and Springs are planned in kit form for all type coaches.
- Preparation of offline nesting programme for components of NEW coach variants LWLRRM, TRC, RDSO Staff Car along with Offline Programme of regular coach variants LWSCN, LGS, LWACCW, LWACCN for nearly all CNC machines like LCM, LCWM, Underwater Plasma Cutting Machine, Oxyacetylene, CNC Vertical Spindle Modular Machine etc.
- Preparation of Spot Welding offline programme of Side wall and Roof of LWLRRM coach variants at Robotic Spot Welding Machine.
- Material planning of additional LHB Bogies and fully assembled wheel set as allotted by Railway Board under RSP and supply to different Zonal Railways as per allotment.
- Preparation of Load chart and Working Instructions for new coach variants i.e. TRC, LWLRRM, RDSO staff car etc.
- Zero based manpower assessment for 2000 coaches.
- Preparation of Coach costing for newly built coaches like HUMSAFAR, ANTYOADYA, and DEENDAYLU made on TURNKEY BASIS considering all variable along with Coach costing of regular coach variants.
- Liability accountal under WMS 7200.

10.0 Machinery & Plant

10.1 Availability of Key M&Ps

Description	2017-18
EOT Cranes	96.27%
Fork Lifter (FLT)	94.27%
Welding Plant	More than 98%
Traverser	99.11%
Skin Tensioning	99.52%
Shuttle Car	99.91%
Out Door EOT	99.90%
Critical Machines	More than 92%

10.2 Working with minimum manpower

Category of Staff	2017-18
Mechanical staff	126
Electrical staff	17
Ministerial staff	2

10.3 Spare & Consumables Planned & procured

Description	2017-18
Total Indent Submitted	155
Total P.O. placed	130
Material received against P.O.	116

10.4 Availability of Fire Fighting Equipments

S.N	Equipment Name	Qty.	U/Maint.	% Availability
1.	Multipurpose fire tender on Ashok Lend 1616.	1	Centrifugal water pump is under breakdown since 19/04/18. The same is under repair. Machine is in working condition.	100%
2.	WATER BOWSER, Make:	1	NIL	100%

	Ashok Leland 2516.			
3.	WATER MIST Fire Make: TATA 407	1	NIL	100%
4.	TRAILAR MOUNTED FIRE PUMP	1	NIL	100%
5.	Pump House-1, Jockey pump	1	NIL	100%
6.	Pump House-2, Jockey pump	1	NIL	100%
7.	Pump House-2, Main pump-1	1	NIL	100%
8.	Addressable manual Call Point	142	NIL	100%
9.	Loop Powered Addressable Base Mounted sounder	66	NIL	100%
10.	Optical beams Smoke detector	70	NIL	100%
11.	Hydrant Points	259	01 no. rejected	99.60%
12.	Fire extinguishers	872	06 nos. rejected	99.30%



Electrical

GENERAL

Electrical Power Supply at 132 KV is received at Main Receiving station (MRS) through a dedicated transmission lines running between MVVNL Grid Substation at bachharawa (about 8.5 km and Main receiving substation (MRS) at Modern Coach factory, Raebareli MRS, 132 KV with the help of two power Transformer of 1.5 MVA each (viz TR-I & TR-II) At any instance, only one of the feeder power supply and other acts as stand by.

Stepped down supply from Transformer is fed to 11 KV panel at MRS. 4 Nos. DG sets of 1010 KVA capacities are working at MRS as backup in case of supply failure /maintenance work of switch yard etc. at MRS.

11 KV supply is further distributed to 10Auxiliary Station and 10 (CSS) compact substation through

Ring main system. The substation are numbered From ASS.1 to 10 workshops and 4 nos. in colony)

At substation, it is further stepped – down to 415V through 750KVA, 11 KV/415 V transformers for

Feeding to various Shops, MCF Colony, Administration Building, service Building, Pumps etc, through LT Panels at Sub- Stations.

A. Planning and Production of Power car- Planning of all materials related to Power Car was done exhaustively and first LHB Power Car was manufactured in Sep-2017 and afterwards 25 no. LHB Power Cars were produced in Year 2017-18.

B. Furnishing of Budget announced Coaches-

4 rakes (80 Coaches) of Humsafar coaches, 17 Antyodaya Coaches and 85 of Deendayalu Coaches were furnished.

C. Outsourcing of WSP work in all AC coaches and non AC coaches was done successfully.

D. Outsourcing of all stage work in Power Car was done successfully.

E. Increase in out-turn: During the 2017-18 furnishing of LHB coaches increased approx. 23% more in comparison to out-turn of previous year 2016-17.

F.

Type of coaches	No. of coaches furnished during 2016-17	No. of coaches furnished during 2017-18	%Increase
LWACCN	94	185	+ 96.81%
HUMSAFAR	101	89	- 11.88%
LWACCW	20	34	+ 70.00%
LWSCN	267	231	- 13.48%
LWS	67	45	-32.84%
LSA	27	17	-37.04%
LWS/ DDG	0	45	100.00%
LWS/ DDF	0	40	100.00%
LWLRRM	0	25	100.00%
Total	576	711	+ 23.44%

A. Power supply system of MCF/RBL consists of the following:

1. **132/11 KV MRS (Main Receiving Sub Station) – 02X12.5 MVA Transformer**
2. **33/11 KV Sub Station (ASS) - 01X10 MVA Transformer**
3. **Auxiliary Sub Station (ASS) – 03X750 KVA -30 nos. Transformer**
4. **Compact Sub Station (CSS) – 01X750 KVA – 10 nos. Transformer**
5. **Compact Sub Station (CSS) – 02X1250 KVA – 02 nos. Transformer (for solar plant)**
6. **Solar Power Plant – 02 MW**
7. **Additional solar plant of 1 MW – Commissioned on 11.11.2017**
8. **DG sets-**
 - a) 04X1010 KVA installed at 132/11 KV MRS
 - b) 01X380 KVA DG set for hospital at present placed at 33 KV sub-station
 - c) 01X125 KVA DG set at Lucknow rest house
 - d) 01X10 KVA DG set at MRS (spare)

B. Sanctioned Load-

- 3000 KVA ON 132/11 KV
- 1000 KVA ON 33/11 KV

C. Average unit consumption per month in year (2017-18) -1353400 KWH

D. Power generation by solar plant during (2017-18) – 34.16 Lakh units

E. Miscellaneous Electrical Assets:

- Total no. of solar street lights with 75 Ah Bty. (15 W LED) – 512 nos.
- Total no. of street lights (45/60W LED) – 2169 nos.
- Total no. of high masts (9.6 KW MH) – 64 nos.
- Total no. of induction lamp (200 W) – 2328 nos. (in factory area)
- Total no. of light pipes – 1471 nos. (in factory area)



Annual Report of Project department 2017-18

History of project:

Modern coach factory, Raebareli is a green field project built on philosophy of using environment friendly sustainable technology for manufacturing processes and use of energy efficient devices with focus on non conventional energy and green buildings. The objective of this project is manufacturing of modern design stainless steel LHB coaches for the Indian Railways.

Various Mile Stone

Foundation stone laid	Feb'2007
Land acquired	Aug'2007-09
Construction work commenced	May'2010
Commissioning of 33 KV line	Jan'2011
Finishing & Furnishing shops completed	Apr'2011
First LHB coach furnished (Shell & Bogie by RCF/KXH)	Apr'2011
Dedication of factory to the Nation	Nov'2012
First shell assembly (Major sub assembly by RCF/KXH)	July'2013
First bogie manufacture	Aug'2014
First LHB shell from raw material of stage onward	Aug'2014
Complete bogie assembly	Dec'2014
Rail Coach Factory, Raebareli Renamed as Modern Coach Factory, Raebareli	22 Dec' 15
300 th LWACCN Coach Furnished	16 Jan' 16
1 st Rake of Humsafar Coaches dispatched	Nov'2016
1 st Rake of Antyodaya Coaches dispatched	April'2017
1 st Power Car shell manufactured	11 th May' 17
1000 th Shell manufactured	20 th May' 17

Annual Performance 2017-18

Modern Coach Factory, Raebareli is being set up at the total cost of Rs. 3192 Cr, for producing LHB design stainless steel coaches with production capacity of 1000 coaches per annum. Factory is being setup on turnkey basis and

the contract is awarded to M/s IRCON International on nomination basis. During the FY 2017-18, following works got completed:-

M&Ps Commissioned in 2017-18: (Rs.1196.12 Lakhs)

S.No.	Machine Name	Qty.	Cost in Lakhs Rs
1	Pre-assembly Ferrule Crimping m/c	2	9.45
2	Jig saw	15	2.62
3	Portable drill cum driver Battery Operated	8	0.54
4	Hand Drilling Machine-13mm	15	0.43
5	Spanner Set (ring type)	10	0.15
6	Circular Saw	3	0.39
7	SIKA Applicator	25	1.19
8	Universal Testing Machine	2	10.44
9	Fork Lift - 10 MT (1 no. for MH & 2 nos. for Stores)	3	47.64
10	Lockers for Workers (12 lockers per cabinet)	300	50.36
11	Synergic CO2Welding Sets	100	398.19
12	EOT Crane - 10 MT (3 nos. for Bogie Shop)	3	129.89
13	EOT Crane - 5 MT (1 no. for Bogie Shop)	1	33
14	Load Lifting & Turning Device (Rotomax type Manipulator for turning Underframe – 10 T capacity (Stage – III/IV))	01 Set	33.73
15	CNC Pipe Bending Machine	1	149.23
16	Heating oven for PVC Roll size 2mx1.2mx1.5m heating cap 50C	2	10.53
17	Heating oven for Sika	5	1.85
18	Flat Pallet(1000 flat pallets for Rs. 235 lacs already purchased out of total 2916 pallets for Rs. 684.39 lacs)	1166	199.28
19	Hydraulic Crane - 10 MT	1	11.1
20	Wet Mop Vacuum Sweeper	2	35.64
21	Rofin RF Tubes for Laser Cutting Machines	2	37.88
22	Gloss meter	1	1.53
23	Low and High Impedance Analyzer	1	19.47
24	Hydraulic Jack 02 Ton	1	0.09
25	Hydraulic Jack 01 Ton	1	0.1
26	E-Rickshaw	8	11.4
	Total		1196.12

Civil works completed and taken over in 2017-18: (Rs. 4559.04 Lakhs)

S.No.	Description of assets	Cost in Lakhs Rs
1	Hazardous waste disposal	4.04
2	Open Air Theatre	294.00
3	External Development of Type-II, III, IV DS	153.00
4	Senior Secondary School	861.00.
5	RPF Barrack	337.00
6	Embedded Track (Workshop)	2039.00
7	SSE building	
8	XEN Building	
9	Toilet cum parking Block	
10	Laboratory complex	
11	Sever line office Block	
	Total	4559.04

Electrical works completed and taken over in 2017-18: (Rs. 777.00 Lakhs)

S.No.	Description of Elect. assets	Cost in Lakhs Rs
1	Solar Power Plant 1 MW	777.00
	Total	777.00

Augmentation of production capacity (A New work sanctioned in PH-42) in FY 2018-19:-

A work of augmentation of production capacity from 1000 to 2000 coaches per year (Phase-1) is sanctioned vide Pink Book 2018-19 Item No.2 of MCF with # tag). It is decided to run the factory in 3 shifts for getting 1500 coach capacity with the existing facilities. For additional 500 coaches/ annum detailed estimate is sanctioned at the cost of Rs.477.85Cr as detailed below:

Sr. No.	Department	Estimated value (Rs. in Crs)	Allocation (Capital)
1.	Civil	209.04	4260
2.	Mechanical	191.70	4275
3.	Electrical	31.73	4277
4.	S&T	3.04	4278
	Total	435.52	
	D&G @ 8.72%	37.97	4280
	Cont. @ 1%	4.35	4290
	Grand total	477.85	

Funds to the tune of Rs. 10.00 Lakhs only are allotted for FY- 2018-19.

Training Proposal submitted to Railway Board for M&P Operation & Maintenance in 2017-18:-

S.N	Name of Machine	No. of Persons	Cost of Training
1.	CNC Turning Centre (M/s Gildemeister Drehmaschinen, Germany)	4	20000 Euros
2	CNC Stretch Bending Forming Machine (M/s Cyril Bath, USA)	4	Free of cost
3	CNC Bolster Machine Centre (M/s TOS KURIM, Czech Republic)	4	Free of cost
4	CNC Bed Milling Machine (M/s TOS KURIM, Czech Republic)	4	Free of cost
5	CNC Bogie Frame Machining Centre (M/s Shin Nippon Koki, Japan)	4	Free of cost
6	Automated Wheel & Axle Line (M/s DANOBAT, Bergara, Spain)	31	183,796 Euros

Sanctioned is awaited, till 22.05.2018.

Senior Secondary School:

Work of Senior Secondary School has been completed and building is hand over to Kendriya Vidyalaya in August 2017. School up to class 10th is made operational, with independent Branch of MCF/RBL.



Senior Secondary School

Open Air Theatre:

For recreation of employees of the Modern Coach Factory, work of Open Air theatre has been completed in March 2018 and made operated.



(Open Air Theatre)

Energy efficient measures:

One additional 1 MW solar power plant is completed and commissioned in March-2018, making the total solar power installation of 3 MW.



1 MW Solar Power Plant

Financial Progress:

Total Rs. 131.15 Cr. expenditure has been made during the year 2017-18 against Final modification Rs. 131.00 Cr. Details of sanction and Expenditure are as given below-

Fig. in Cr. Rs

ITEM	IRCON						VA T/ GS T	CRI S/ IT	MC F D& G	Gra nd Tota l
	Civil	Mec h	Elect	S & T	D& G	Adv				
Sanctioned RE	1396.2	1232.2	283.06	19.77	113.24	0.00	0.0	49.24	98.27	3192.0
FM 2017-18	50.0	20.5	7.0	1.0	10.5	-7.00	15.00	1.00	6.9	131.0
Expenditure in 2017-18	53.23	22.14	6.35	0.05	10.52	-8.95	16.12	0.43	6.73	131.15
Balance work	150.77	278.88	37.27	-0.25	14.48	-35.77	0.00	22.83	21.08	468.15



STORE DEPARTMENT

**Total Value of stores purchased during 2017-18
PROFORMA-I**

(Rs. IN Crores)

Sr. No.	Item	Value
A	Imported Direct	14.57
B	Imported Stores Purchased in India	48.35
C	Stores Purchased from PSUs	56.63
D	Khadi Purchase	0.35
E	Stores purchased from Cottage & SSI units	772.25
F	Other indigenous	388.46
	Total	1280.61

**Total Value of stores purchased during 2017-18
PROFORMA-II**

(Rs. IN Crores)

Sr. No.	Item	Value
A	Stores for operation/repair & maintenance	0
B	Stores for construction	0
C	Fuel	0
D	Components/Stores purchased for manufacture of complete rolling Stock and complete units of Rolling Stock.	1280.61
	Total	1280.61

**Total Value of stores purchased during 2017-18
PROFORMA-III**

(Rs. IN crores)

Sr. No.	Item	Value
A	Through Department of Supply (DGS&D)	0.00
B	Through Railway Board	67.95
C	Direct Purchased made by Railway/PU	1212.66
	Total	1280.61

ANNEXURE-III
STATEMENT NO 39-A

Stores Transaction during the year 2017-18

(Rs. In Thousands)

Headings	Opening balance (at the beginning of the year 2017-18)	Receipts during the year 2017-18)	Issues during the year 2017-18)	Closing balance (at the end of the year 2017-18)
Stream loco parts and fittings	0	0	0	0
Diesel loco parts and fittings	0	0	0	0
Electric loco parts and fittings	0	0	0	0
Carriagel, wagon, EMU parts and fittings	1049596	12340089	12008242	1381443
Electric stores	2931	110167	84713	28385
Signal and Tele-com stores	0	0	0	0
P.Way material, track, tools etc.	0	0	0	0
Engg. Stores covering bldg. Material etc	4876	3402	1852	6426
Abrasive tools,hardware etc,	19705	7565	9071	18199
Brushes, brushware etc.	629	59	401	287
India rubber, leather canvas etc.	9320	81215	72291	18244
Electordes & welding accessories	6895	39823	38331	8387
Paints,enamels & varnishes	1283	25117	22752	3648
Crockery, cutlery & napery	51	23	73	1
Cloth,clothing & personal equipment.	4078	7856	9859	2075
Petroleum products other than fuel oil	1102	1490	1721	871
Refractories, packing material etc.	2153	16853	17053	1953
Ball & roller bearings	0	0	0	0
Genl. Stores covering acids, chemicals etc.	1414	36021	34354	3081
stationery forms etc.	1362	2916	2427	1851
Metal ferrous	22958	65210	36762	51406
Metal non-ferrous	28	44	15	57
Fuel-coke, coal etc.	0	0	0	0

Fuel-oil	0	0	0	0
Timber	4856	19125	13943	10038
Scrap	5760	49140	54900	0
Rolling Stock complete units 7 stores	0	0	0	0
Total	1138997	12806115	12408760	1536352
Adjustments	0	0	0	0
Grand total as per App. Account	1138997	12806115	12408760	1536352

VALUE OF STORES PURCHASED DURING 2017-18

(Rs. In Thousands)

S N o	Heading	Value of Stores Imported Direct				Value of Imported Stores Purchased in India				Value of Stores Manufactured in India or Indignep				G. Total
		Stock	Non-Stock	Conssn Work	Total	Stoc k	Non-Stock	Consstn Work	Total	Stock	Non-Stock	Const n Work	Total	
1	Steam Loco parts and fitting	0	0	0	0	0	0	0	0	0	0	0	0	0
2	Diesel loco parts and fittings	0	0	0	0	0	0	0	0	0	0	0	0	0
3	Electirc loco parts and fittings	0	0	0	0	0	0	0	0	0	0	0	0	0
4	Carriage, wagon, EMU parts and fittings	145774	0	0	145774	483599	0	0	483599	11710716	0	0	11710716	12340089
5	Electrical Stores	0	0	0	0	0	0	0	0	110167	0	0	110167	110167
6	Signal and Tele-com. Stores	0	0	0	0	0	0	0	0	0	0	0	0	0
7	P.Way material, track, tools etc	0	0	0	0	0	0	0	0	0	0	0	0	0
8	Engg. Stores covering bldg.	0	0	0	0	0	0	0	0	0	3402	0	3402	3402

	Material etc.													
9	Abrasive tools, hardware etc.	0	0	0	0	0	0	0	0	7565	0	0	7565	7565
10	Brushes, brushware etc.	0	0	0	0	0	0	0	0	59	0	0	59	59
11	Indian rubber, leather canvas etc	0	0	0	0	0	0	0	0	81215	0	0	81215	81215
12	Electrode & welding accessories	0	0	0	0	0	0	0	0	39823	0	0	39823	39823
13	Paints, enamels & varnishes	0	0	0	0	0	0	0	0	25117	0	0	25117	25117
14	Crockery, cutlery & napery	0	0	0	0	0	0	0	0	0	23	0	23	23
15	Cloth, clothing & personal equipment	0	0	0	0	0	0	0	0	7856	0	0	7856	7856
16	Petroleum products other than fuel oil	0	0	0	0	0	0	0	0	1490		0	1490	1490
17	Refractories , packing material etc	0	0	0	0	0	0	0	0	16853	0	0	16853	16853
18	Ball & Rollar bearings	0	0	0	0	0	0	0	0	0	0	0	0	0

19	Genl. Stores covering acids chemicals etc	0	0	0	0	0	0	0	0	36021	0	0	36021	36021
20	Stationery forms etc.	0	0	0	0	0	0	0	0	2916	0	0	2916	2916
21	Metal ferrous	0	0	0	0	0	0	0	0	65210	0	0	65210	65210
22	Metal non-ferrous	0	0	0	0	0	0	0	0	44	0	0	44	44
23	Fuel-cock, coil etc.	0	0	0	0	0	0	0	0	0	0	0	0	0
24	fuel-oil	0	0	0	0	0	0	0	0	0	0	0	0	0
25	Timber	0	0	0	0	0	0	0	0	19125	0	0	19125	19125
26	Scrap	0	0	0	0	0	0	0	0	49140	0	0	49140	49140
27	Rolling Stock complete units & stores	0	0	0	0	0	0	0	0	0	0	0	0	0
	Total	14577 4	0	0	1457 74	4835 99	0	0	4835 99	12173317	3425	0	12176 742	12806115

STATEMENT NO. 39 B

Summary statement of Stores transactions during 2017-18

(Rs. In Crores)

39(B)- Summary Statement of Stores transactions on Govt. Railway in 2017-18									
Opening bal. At the beginning of the yr.				Trans. Of Phy. Stock		Closing bal. At the end of the year			
Phy. Bal without adjustments (7160)	Adjustments (7100 to 7150)	Balance under (7100 to 7150)	Total stores (7100 to 7160)	Receipts	Issues	Phy. Bal without adjustments (7160)	Adjustments (7100)	Balance under (7100 to 7150)	Total stores (7100 to 7160)
1	2	3	4	5	6	7	8	9	10
90.05	0.000893	-48.85	41.2	1280.61	1240.87	131	0.00089258	-96.64	34.36



Accounts

1.0 PROJECT

The project estimate was originally sanctioned under Capital 4200 (Raebareli-setting up of new Modern Coach Factory) at the cost of Rs. 2556.84 crore which has been revised to Rs 3192.00 crore vide letter no. 2016/M(W)/964/3 dated 21/05/2016

The Total expenditure under final heads for fixed assets and M&P is Rs 2669.71/- crore upto March, 2018. This includes expenditure incurred on project cost of MCF (Capital) 4200 and machinery & plant (Cap-4100).

The Closing balance of floating assets (Inventories Cap-7100, Cap-7200 and Cap-7300) is Rs. 116.38 Crore. The break-up of fixed and floating assets is as under:-

(Rs. in Crore)

Fixed Assets			Break up of fixed assets by important categories	
(a)			Fixed Assets	Amount
(a)	Project Township	245.40/-	Preliminary Expenditure	14.90/-
(b)	W/s & offices	2424.31/-	Land	51.87/-
	Total Fixed Assets (a+b)	2669.71/-	Building and other structural engg. Works including road & permanent way	1247.96/-
II	Floating Asset		Machinery and Plant	1325.15/-
(a)	Stores Suspense	61.90/-	Electrical Installation	
(b)	W/s Mfg. Suspense	54.44/-	General Charges	29.83/-
(c)	Misc Adv. Cap	0.04/-	Total Fixed Assests	2669.71/-
	Total Floating Assets (a+b+c)	116.38/-		
	Total Assets (Fixed & Floating)	2786.09/-		

**2.0 STATEMENT SHOWING DEPRECIATION RESERVE FUND
ACCOUNT FOR AND TO END OF THE YEAR 2017-18**

(fig. In units of Rs.)

S.No.	PARTICULARS	AMOUNT
01	Opening balance	NIL
02	Appropriation during the year 2017-18	NIL
03	Interest during the year @ 5%	NIL
04	Total (2+3)	NIL
05	Expenditure on renewals & replacement during the year 2017-18	NIL
06	Net accretion to the fund during the year 2017-18 (4-5)	NIL
07	Closing balance (Col. 1+6)	NIL
	Details of Grant for 2017-18	NIL
	Original Grant	NIL
	Supplementary	NIL
	Residual	NIL
	Final Grant	NIL

**3.0 STATEMENT SHOWING PENSION FUND ACCOUNTY FOR AND TO
END OF THE YEAR 2017-18.**

S.No.	PARTICULARS	AMOUNT
i	Opening balance	-20847825/-
ii	Appropriation during the year 2017-18	22200000/-
iii	Transfer from contribution of PF	0
iv	Total (ii+iii)	22200000/-
v	Withdrawals during the year 2017-18	23693446/-
vi	Net accretion to the fund during the year 2017-18 (v-vi)	-1493446/-
vii	Interest during the year @ 5.75%	-1241687/-
viii	Closing balance (Col.i+vi+vii)	-23582958
	Details of	Amount of Grants
	Grants for	2017-18
	Original Grant	57300000/-
	Supplementary	0
	Grants for	0
	Residual	-35100000/-
	Final Grant	22200000/-

4.0 MANUFACTURING SUSPENSE ACCOUNT FOR THE YEAR 2017-18

DEBIT SIDE		CREDIT SIDE (Rs in Unit)	
PARTICULARS	01/04/2017 - 31/03/2018	PARTICULARS	01/04/2017- 31/03/2018
01. Work in Progress as on 01/04/2017	58,17,66,53 3	01. TRANSFER TO RLY	----0----
Total (A)	58,17,66,53 3	(i) SUPPLY OF COACHES	15,21,83,51,1 69
B- LABOUR		(ii) MISC SUPPLIES	----0----
01. WORKSHOP DIRECT LABOUR	30,95,96,83 2	02. BY CAPITAL STORE	----0----
03. INDIRECT LABOUR	27,15,12,30 7	(i) MANUFACTURING	----0----
04. SALARY AND ALLOWANCES OF ADM	50,02,89,94 8	(ii) RETURNED STORE	----0----
05. WORK CONTRACT	15,81,49,12 9	03. BY CAPITAL WORK DONE PLANT AND MACHINERY & OTHER WORK	----0----
06. SALARY AND ALLOWANCES OF STORE	3,97,15,038	04. BY WORK DONE ON DEPOSIT ACCOUNT	----0----
07. SALARY AND ALLOWANCES OF TOWNSHIP	5,14,97,338	TOTAL CREDIT	15,21,83,51,1 69
TOTAL LABOUR	1,33,07,60, 592	05. BY EXPORT	
C- STORE		06. BY CLOSING BALANCE (WIP AS ON 31/03/2018)	62,60,34,343
01. STORE DIRECT FROM STOCK	12,15,51,56 ,236		
02. STORE DIRECT FROM DDO	1,58,90,71, 336		

03.ADJUSTMENT	60,66,809		
04.INDIRECT STORE (FOH)	9,88,81,783		
05.FOH DDO	5,32,50,632		
06.FOH ADJUSTMENT	- 11,47,00,52 1		
07.INDIRECT STORE (AOH)	17,81,200		
08. AOH DDO	13,45,31,73 2		
09. AOH ADJUSTMENT	- 21,74,78,55 9		
10. INDIRECT STORE (SOH)	---0---		
11. SOH DDO	10,98,55,28 8		
12. SOH ADJUSTMENT	-22,10,023		
13. INDIRECT STORE (TOH)	----0----		
14. TOH DDO	3,37,03,888		
15. TOH ADJUSTMENT	-----0-----		
16. RETURNED STORE	- 10,27,45,37 0		
17. MISC. ADJ. (TR) DR/CR FROM TO	4,11,36,343		
TOTAL – STORES	13,78,63,00 ,774		
OTHER CHARGES	-----0----		
01.APPRO. TO PENSION FUND	4,13,42,961		
02.AOORO. TO DRF	-----0-----		
03.APPRO. TO	22,75,200		

SBF			
04.ELECTRICITY (POWER)	11,15,20,33 3		
05.STOCK ADJUSTMENT	-----0-----		
06.FRIEGHT INDIRECT	-----0-----		
07.MISC. INDIRECT	-----0-----		
TOTAL -OTHER CHARGES	15,51,38,49 4		
(E) RECOVERIES			
01.RECEIPT ON RENT AND WATER	-39,25,723		
02.RECEIPT ON ELECTRICITY	-5,65,5,158		
TOTAL- RECOVERIES	-95,80,881		
TOTAL(WITHOUT OPENING BAL.) F=(B+C+D+E)	152626189 79		
TOTAL (WITH OPENING BAL.) G =(A+F)	158443855 12	TOTAL	15844385512



Civil Engineering Department

General-

- 1.1 MCF/RBL complex at Lalganj District Raebareli is spread over 540 Hectares of land out of which Workshop area is 187 Hectares, township area 335 hectares and remaining 18 hectares is used in rail connectivity from Lalganj railway station.
- 1.2 Workshop comprises approx. 1.93 lakh sqm covered structures. There are 1272 staff quarters (872 type-II, 240 type-III & 160 type-IVDS) including several service buildings in workshop and township. Besides, there are several community facilities such as shopping complex, school, clubs and rest houses separately for workers, supervisors and officers. Balance works of the establishment of MCF are in progress. Beside this sanction available for 96 type-II & 400 Type-III quarters out of which construction of 320 type III Quarters is in progress. Cost of occupied/commissioned Civil Engg. assets is Rs. 1125 Cr. (approx.)
- 1.3 Dense forestation of 40000 trees has been done in township side in consultation with Forest Department UP. Including this total plantation done so far in MCF is 75000 trees. Nature of soil in MCF is alkali (Usar). Efforts are being made to cover entire area of campus with plantation/greenery and maintain it suitably. On the basis of NBRI report 3000 tree plantations have been done so far in Monsoon 2018.
- 1.4 IMS certification for workshop is in under process. Main emphasis is given on conservation of natural resources and to provide green & eco friendly environment. Entire sewage of factory and township is being treated in STPs (capacity 1.1MLD + 0.4 MLD in township and 1.1 MLD in factory). Treated water distribution network for its use in irrigation of greeneries & plantation is planned for commissioning in FY 2018-19.
- 1.5 Assets are being maintained regularly on planned manner with minimum departmental labour. General sanitation & horticulture

activities are being outsourced along with other civil engineering maintenance works & special sanctioned works. Efforts of Civil Engg. Deptt. are to maintain assets regularly in due time with economical methods. All efforts are being made to maintain pollution free and pleasant environment in this Production Unit of Indian Railways.

- 1.6 Pre-fabricated structure with double layered roof sheeting has been used in various sheds of workshop. Large window openings with adjustable louvers have been provided to reduce the effect of heat in summer in most workshop structures, Skylights have been provided in roofs to facilitate day light and conserve electricity.
- 1.7 Central Park and Open air Theatre has been Commissioned.

2.0 Organisation setup-

- 2.1 Civil Engineering Department is headed by Chief Engineer, who is assisted by 02 Dy. CE & 02 XENs.

Detail of sanction/on roll staff in engineering department is as under;

Category		Sanc. Strength	On Roll	Vacancies
Officers		12	06	06
Group 'C'	Supervisor	22	14	08
	Ministerial	13	08	05
	Artisan	27	12	15
Group 'D'		42	23	19
Total		116	63	53

There are 9 SSE/JE/W to maintain building & structures and 2 SSE/P-ways to maintain rail connectivity network along with handling of special sanctioned and project works.

3.0 Main features-

3.1 Water Supply

There are 3 tube wells in colony and 2 tube wells in workshop each with pumping unit. Requirement of water supply in colony as well as in workshop is met with through 200mm dia, deep tube-wells (320m to 360m) having enough yield. Water from the tube wells is pumped to over head tanks. Total capacity of available 5 over head

tanks is 2025 KL. Individual capacity and location of these overhead tanks is as under.

OHT No.	Location	Capacity (KL)	Staging
OHT 1	Near type-II Colony in township	600	22 m high
OHT 2	Near type-V Colony in township	300	22 m high
OHT 3	Near type-IVDS Colony in township	450	22 m high
OHT 4	Near Gate No. 2 of Workshop	225	22 m high
OHT 5	Near MRS of Workshop	450	22 m high

Total length of main water pipe line in township is 25.50 km and in workshop is 16.00 km.

Average daily requirement of water is about 2250 KLD (1800 KLD for Township and 450 KLD for Workshop). Every effort are being made to reduce consumption of ground water by providing push cock type taps at public places and prevent leakages from roof top tanks. This demand will further reduced drastically after commissioning of distribution network of treated effluent for irrigation of lawns/greeneries in workshop and parks, service buildings, playgrounds and Type-IV & V quarters in township.

3.2 Rain Water Harvesting

Water requirement of MCF is met through ground water. To prevent depletion of ground water table of the area with the passage of time, an exhaustive plan of RWH in factory and township has been finalised to directly recharge 33% annual extracting quantity against 25% as per norms. These RWH pits and network is likely to commission before monsoon of 2018.

3.3 Fire Fighting Arrangements

Sufficient fire hydrants at strategic points in the workshop and administrative building have been installed to meet emergency requirement. 1 static ground water tanks of capacity 900KL and 01elevated tank of capacity 332KL has been provided.

3.4 Sewerage System

Sewerage system is separate from storm water drains. The sewage is carried to sewage treatment plants (STP) 1.1 MLD near type-II colony, 0.4 MLD near type-IVDS colony and 1.1 MLD in factory. These STPs are working on SBR technology. The details of sewers are as under.

SN	Description	Length(meter)	
		Workshop	Township
1	SW 200mm dia	4537	7725
2	SW 250mm dia	2011	2410
3	SW 300mm dia	-	888
4	RCC pipes 300mm dia	-	904
5	RCC pipes 350mm dia	465	1185
6	RCC pipes 400mm dia	696	-
7	RCC pipes 450mm dia	210	1907
8	RCC pipes 500mm dia	-	1588
9	RCC pipes 600mm dia	-	2142
10	RCC pipes 600mm pipe NP2	-	50
11	RCC pipe 800 mm Pipe	-	3370
Total		7919	22169

3.5 Storm water drains-

Entire MCF complex has a well planned open drainage and covered drainage system network which is ultimately discharge into natural drain (Mathana Nala) available in campus. Drainages are planned along both sides of main roads. To ensure proper functioning of storm water drains cleaning of drains before on set monsoon is being ensured. Detail of storm water drainage is as under;

SN	Description	Length(Meter)	
		Workshop	Township
1	RCC covered drain	9015	5000
2	RCC open drain	6296	15000
3	Brick drain (open)	-	9000
Total		15311	29000

3.6 Service roads-

There is well planned service road network. Details of road is as under

SN	Description of Road	Area(Sqm)	
		Workshop	Township
1	CC Road	82785	-
2	Bituminous Road	11123	219257

3.6.1 Other features of Civil Engineering Department of MCF are as under

Land

Private land	283Ha
Govt land	189Ha
Gram Sabha land	68Ha
Total	540 Ha
(Book Value approximate 60cr.)	

3.7 Boundary Wall (km)

(i) Township	10.78 Km
Workshop	5.50 Km
Total	16.28 Km.

Entire premises of MCF/RBL are enclosed with gap less boundary.

(ii) Fencing/boundary wall of assets

Location	Brick walled	Fabricated concrete panel	Expansion metal/chain link fencing	Total length (Meter)
Township	14013	1107	30555	45675
Workshop	3457m	0	0	3457
Total	17470	1107	30555	49132

3.8 Residential Accommodation

Type	No. of quarters
II	872
III	240
IVDS	160
IVSS	70
V	46
VI	4
GM Bungalow	1
Total	1393

3.9 Workshop Structures (sqm)

- (i) Covered area = 269800
(ii) Un-covered area = 139318

3.10 Other Structures (sqm)

- (i) Service Buildings = 6858
(ii) Anc. Build. in Workshop = 8600

3.11 Welfare Buildings (sqm)

- (i) Township = 17362
(ii) Workshop = 3850

3.12 Track

Description	Length(Km)
Ballasted Track	7.905
Embedded Track	13.318
Points & crossing	17Nos

4.0 Expenditure during financial year 2017-18

(Rs.inTh)

SN	Plan head	Allocation	Expenditure
1	4200	Cap	674330
2	7200	WMS	71505
Total			745835

5.0 Major Achievement of the year 2017-18

- Commissioning of Central park along with Monumental flag.
- Development of Greenery in the MCF campus (15000 Nos. trees).
- Engineering Earning of MCF/RBL under lease rent etc is Rs. 5.25 crores (approx).
- Civil engineering assets of Amount Rs. 30 Crores have been taken over from M/s IRCON in this year.
- Cleaning of 15 hectare of wild area in factory has been done through outsourcing. This wild area was not cleaned earlier as this area is not covered under constructions area.
- Bill of amount Rs. **67.30 crores** received from M/s IRCON has been cleared in financial year 2017-18.
- Contract of
 - Hiring of vehicles for officers,
 - Two wheeler parking in factory,
 - Concrete flooring in factory,
 - Sweeping of roads in factory,
 - Maintenance contract for factory yard & MCF siding,
 - Balance road along boundary wall in Township and Workshop,
 - Civil assets maintenance contract of Township.have been awarded successfully in this year.

- Contract awarded for Alambagh (Phase-I) and Kota Workshop (Phase-I) and start of these works.
- Followings buildings/shed assets have been constructed and many of them started to utilise.
 - Water recycling pipeline network to use STP treated water in irrigation of Eco work.
 - Cycle path in township
 - Additional 30m embedded track along Wheel shop
 - one additional toilet block in factory
 - 03 nos. additional office cum locker room in factory



Personnel

1. Over all Cadre position of MCF/RBL as on 31.03.2018 after ministerial cadre restructuring:-

S.No.	Category	Revenue	W/C	Total	On Roll	Vacancy
1	Gazetted	148	24	172	123	49
2	Supervisors	339	48	387	335	52
3	Artisan	1279	00	1279	1160	119
4	Ministerial	239	08	247	202	45
5	Others (A/C, RPF, Med.)	158	12	170	109	61
6	Group-D	497	15	512	473	39
Total		2660	107	2767	2402	365

a) Cadre of Gazetted Officers:-

The staff strength of Gazetted cadre during the year 2017-18 is given below:-

S.No.	Category	Revenue	W/C	Total	On roll	Vacancy
1	HAG+	01	00	01	01	00
2	HAG	01	01	02	01	01
3	SAG	18	06	24	19	05
4	SG/JAG	35	11	46	38	08
5	SS	35	04	39	19	20
6	JS/Group-B	58	02	60	45	15
Total		148	24	172	123	49

b) Cadre of Non-Gazetted Staff:-

The staff strength of Non-Gazetted cadre after ministerial cadre restructuring during the year 2017-18 is given below:-

S.No.	Category	Revenue	W/C	Total	On roll	Vacancy
1	Supervisors	339	48	387	335	52
2	Artisan	1279	00	1279	1160	119
3	Ministerial	239	08	247	202	45
4	Others (A/c, Security, Gen. Admn, Med.)	158	12	170	109	61
5	Group-D	497	15	512	473	39
Total		2512	83	2595	2279	316

2 a) Work Charged Gazetted Posts:-

The details of work charged/temporary gazetted posts created/Extended during the year 2017-18 are as under:-

S.No.	Deptt	Grade	Period of Currency		
			From	To	
1.	Mech	1	01 HAG	Extension up to 30.06.18 is pending in Rly. Board.	
		2	02 SAG		
		6	06 JAG/SS/JS		
2.	Per	1	01 SAG		
		3	03JAG/SS/JS		
3.	Acct	1	01 SAG		
		3	03 JAG/SS/JS		
4.	Store	1	01 SAG		
		3	03 JAG/SS/JS		
5.	Civil	1	01 SAG		
		1	01 JAG/SS/JS	30.06.2017	30.06.2018
6.	S&T	1	01 JAG/SS/JS	30.06.2017	30.06.2018
Total		24			

b) Work Charged Non-Gazetted Posts:-

The details of work charged/temporary non-gazetted posts created/Extended during the year 2017-18 are as under:-

S.No	Deptt.	No. Of Posts	Period of Currency	
			From	To
1.	Supervisor	48	01.04.2017	31.03.2018
2.	Ministerial	08	01.04.2017	31.03.2018
3.	Others (A/c, Security, Gen. Admn, Med.)	12	01.04.2017	31.03.2018
4.	Group 'D'	15	01.04.2017	31.03.2018
Total		83		

Indent Position:- The following Indents have been placed and received during the year 2017-18, their details are as under:-

Category	Indent placed	Panel received	Balance	Remarks
JE (P.Way)	01	---	01	
JE (Works)	02	---	02	
Tech. (Civil)	04	---	04	
TCM-III	02	---	02	
SSE/D&D	00	---	---	
JE/D&D	07	---	07	
Sr. Clerk	00	---	---	
Others (Med & G Branch)	16	---	16	
Total	32		32	

4. APPOINTMENT IN GROUP C&D AGAINST VARIOUS QUOTAS:-

The detail of appointments on various quotas during the year 2017-18 is as under:-

S. No.	Category	For the year 2017-18
1	Compassionate Ground	4
2	Sports Quota	1
3	Ex-Serviceman Quota	0
4	Physical Handicapped Quota	0
5	Crash Programme for wiping out shortfall of SC/ST	0
6	Casual Labour absorbed	0
7	No. of Staff Recruited Scout/Cultural Quota	0
8	Sub. Act App. B/Kh	0
Total		05

5. Settlement Dues:-Total no. of cases in which payment has been made of settlement dues during the year 2017-18.

S. No.	Nature of Settlement	No. of Cases received	No. of Cases Settled	Balance Cases
1	Superannuation	9	9	0
2	Voluntary Retirement	1	1	0
3	Compulsory Retired	0	0	0
4	Resignation	0	0	0
5	Removal & Dismissal	0	0	0
6	Medical Unfit Cases	1	0	1
7	Death Cases	5	0	5
Total		16	10	06

6. PROMOTIONS:-

During the year selections, suitability & Trade Test were conducted. **715** Non-Gazetted employees of various categories have been promoted. **07** employees of various departments have been promoted to Group "B" Gazetted.

Beside this all MACP cases due during financial year have been finalized.

SNo.	Category	Number of staff promoted this year.
1	Gazetted	07
2	Supervisor	44
3	Ministerial	138
4	Artisan	533
Total		722

7. Recruitment:-

87 numbers of candidates have been recruited in the following categories during the period of 2017-18.

S.No.	Category	Recruited
1	Supervisors	33
2	Ministerial	13
3	Technicians	41
4	Group-D	00
Total		87

8. VIP References:-

11 No. of VIP references were received from Railway Board/MPs/MLAs during the year 2017-18. All these references have been finalized in time.

9. BONUS:-

In the years 2017-18 Group-C&D staff of MCF/RBL has been Paid productivity linked

Bonus detail of which is given as below:-

No. of Employees 2017-18	Productivity Linked Bonus (In Rs.)
2121	3,60,13,169

10. Salary Payment during 2017-18:-

No. Of Staff	Amount Paid
Gazetted	17,23,81,230
Non Gazetted	1,04,80,24,467
Total	1,22,04,05,697

11. Disbursement of Advances for the year 2017-18:-

Following advances on various accounts had been disbursed during the year 2017-18 as under:-

HEADS	FUND ALLOTE D	FUND PAID	FUND BAL	No. of Staff	Remark
HBA	50,00,000	0	50,00,000	0	
M.CAR	0	0	0	0	
M.CYCLE/ SCOOTER	0	0	0	0	
COMPUTER	26,50,000	26,50,000	0	53	
CYCLE	0	0	0	0	
TOTAL	76,50,000	26,00,000	50,00,000	53	

12. Online Portals being operated at MCF/RBL:-

- ARPAN
- COMPTRAN
- CPGRAMS
- NIVARAN

13. In house training of Personnel Branch Staff:-

Classes were held for giving basic training to the directly recruited ministerial staff through RRBs for their induction into railways by Personnel Branch officers and all supervisors.

14. Industrial Relation:-

During the year 2017-18, the industrial relations have remained cordial at MCF, Raebareli with not even a single incident of unrest or indiscipline.

15. Staff Contact and Grievance handling:-

First week in each month grievance camps were held within the factory premises and approximately 195 grievances were collected by contacting the staff personally and 182 complaints were disposed of due course. Besides this a drive (KarmchariCamp) was launched for updating of service record and staff was contacting for perusal and updation of the same.

- Karmchari Camp.



16. Staff Welfare

- A branch of KV, Raebareli made operational from Nov 2013 for classes up to 10th standard. Gyanda Bal Mandir School is being run by MCF/WWO.
- Facilities of Loan & membership for Staff of MCF, RBL got co-opted with NR Primary Co-op Bank Ltd. of Lucknow. This society's member of 542 Railway Employees and advantage of loan facilities of 268 society's members.
- Election of General Member NR Co-operative Bank Ltd. Dated 20.04.2017 and elected member in MCF/RBL Sh. Ashish Kumar, Tech., Mech. Deptt. For Co-operative Bank Ltd. Lucknow.
- Operating of E-Rickshaw in MCF Campus Area on dt. 07.06.2017 for facilities of Employee and Employee's family.
- Arranging for First Aid training programmed in Workshop as a Shop wise in MCF/RBL on 21.08.17 to 05.11.17



Enrolment of Railway staff for Territorial Army has been started and **Two MCF Employee is attending the Territorial Army training Camp in last year.**

- Staff grievance camps being held regularly in the factory Campus by All Six Welfare Inspector in under our section.
- Women's Health Check-up Camp was organized in International Women's Day. In this event movie (Padman) was showed on 07.03.18 at Saraswati Auditorium MCF/Raebareli.
- Appointment of Homeopathy Doctor through under Staff Benefit Fund on 08.07.16. Extension of tenure of Homeopathy Doctor under SBF for another one year has been completed on 10.07.18, currently 400 patients are being benefited by this Homeopathy clinic in every month.
- Election of 3 member canteen committee was made on 05.12.2017. Elected members are Sh. Rakesh Kumar, Tech.-II, Sh. Manoj Kumar, Sr. Tech. and Sh. Buddhi Prakash Meena, Sr. Tech.



- **KARMCHARI KALYAN KOSH (KKK):** To provide immediate financial help to the family of employees who die in service, a scheme has been launched under the name of “KKK”. In this scheme, all staff including officers is covered in which immediate relief is provided to the grieved family. During the last financial year a total of 07th employee member are benefited.
- Inter Railway Cultural Dance Competition-2017 was organized as on 17.11.17 & 18.11.17 at Saraswati Auditorium in MCF/Raebareli, in this event first winner of Subrato Bhattacharya in individual Dance and first winner of Western Railway in group dance competition.



- A scarf ceremony, NRBS&G District-MCF/Raebareli as on 05.01.2018 and awareness Rally of Clean India-Health India (Swachh Bharat-Swasth Bharat).



- Dress and Food material was distributed in village-Basantpur Kathoea, Distt.-Raebareli on 12.02.2018 by NRBS&G District-MCF/Raebareli.



- First employee camp-2017 of MCF/RBL was organized is successful from 01.07.17 to 09.07.17. In this camp employee visited Chandigarh, Shimla, Manikaran & Kullu Manali.



- A workshop for empowerment of handicapped employee and handicapped wards of employees was organized by Personnel Department on 28.03.2018.



- A Women employee camp of MCF/RBL to Chitrakoot & Khajuraho was successfully held in 16.02.18 to 18.02.18.



- Scholarship has been distributed to the wards of employees for technical and professional courses for the F.Y. 2014-15, 2015-16 & 2016-17.



- Competition of poster making and essay writing was organized on the subject of Swachhhta Pakhwara-2017 on 23.08.17 & 24.08.17



17. Staff Benefit Fund:-

The staff Benefit Fund Committee continued to function effectively and satisfactorily. Brief particulars of disbursements made for various objectives are as under:-

Description	Expenditure in Rs.
Education of children/works of staff	2,52,000.00
Education of Girls Children of Group-D Staff	Nil
Recreation other than sports	2,04,000.00
Cultural Activities	20,000.00
Relief of distress and Scheme of Sickness.	98,000.00
Miscellaneous.	508.00
Women Empowerment Activities.	1,39,500.00
Recreational facilities at Institutes and Supervisors & Workers Club.	20,000.00
Indigenous system of Medicines including Homeopathic.	2,00,000.00
Financial help to Physically & Mentally/Challenged Children	Nil
Total	9,34,008.00

18. Canteen (Factory premises and Admn. Building):-

One modern and well equipped statutory Staff Canteen has been established in workshop area, which caters to the needs of more than 2500 employees, in supplying Tea/Snacks/Cold-drinks and meals (lunch) etc. It has a seating capacity of 500. One small canteen in Administrative block is also supplying samosas, tea, coffee, soup and cold drinks, lunch to the staff working in Administrative Block.

19. OBSERVANCE OF SADBHAVANA DIWAS :-

Sadbhavana Diwas (22 August, 2017) was observed on 18 August, 2017. All officers had taken pledge in main entrance hall in administrative building and staff had taken pledge at their respective work place through their controlling officers.



20. OBSERVANCE OF THE BIRTH ANNIVERSARY OF LATE SARDAR VALLABH BHAI PATEL “ RASHTRIYA EKTA DIWAS”(NATIONAL UNITY DAY):-

Rashtriya Ekta Diwas (National Unity Day) was observed on 31 October, 2017. All officers had taken pledge in main entrance hall in administrative building and staff took pledge at their respective work place through their controlling officers.



21. OBSERVANCE OF SHAHEED DIWAS:-

Shaheed Diwas was observed on 30 January, 2018. All officers along with staff have taken two minute silence at their workplace.



22. Activities of MCFWWO

One of the major activities of MCFWWO is to the play school named Gyanda Bal Mandir, for the children of employees of MCF/RBL. It is running with 02 class rooms and having a well-equipped play room, kitchen and play area for the children. The school holds various functions on all important dates like Republic day, Independence day, Children's day and Teacher's day

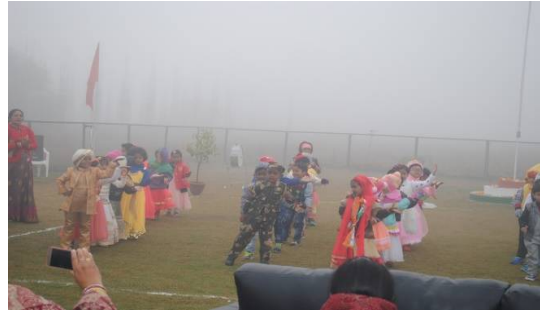



Medical

- 1 Sanctioned strength of Doctors in MCF/RBL Hospital is 14 but only 09 regular Doctors and 03 CMPs, 01 part time dentist and 01 homeopathic doctor are posted. Filling up of remaining post is under process.
- 2 Digital X-ray machine has AMC under process.
- 3 Fully Bio Chemistry Analyser AMC under process.
- 4 Automated Haematology Analyser machine has been installed and working well.
- 5 90 cases of Medical Reimbursement were received and all cases was cleared.
- 6 Dr. O.P. Chaudhary Hospital Lucknow has been empanelled for treatment Of MCF beneficiaries for fourth year consecutively.
- 7 Ajanta Hospital and IVF Center, Lucknow has been empanelled for treatment of MCF beneficiaries for two year consecutively.
- 8 Chandra Eye Care, lucknow has been empaneled foe treatment of MCF beneficiaries for two year consecutively..
- 9 Medenta-The Medicity Global Health Pvt. Ltd. Gurugram has been empanelled for treatment of MCF beneficiaries for two years onsecutively.
- 10 krishna supeer specialty Hospital Kanpur has been empanelled for treatment of MCF beneficiaries.
- 11 Regular indent for medicine are being placed foe procurement through COS. For those not received through indent procurement by local supply order on three quotation basis.
- 12 Urgently required drugs are procured through cash imprest.
- 13 School Health check up camp Women health check up camp and workshop health check up camp & world International Day (women day, cancer day, tuberculosis day and health day) etc were successfully organise.
- 14 ECG MACHINE, Multipara Monitor, Suction Machine, D-Fabricator, AMC under process.
- 15 Total OPD & Emergency patient from 01.04.2017 to31.03.2018 are 45208, 124 average per day.
- 16 815 (Govt:- 262+Empanelled Hospital:-553) of referral Patients from 01.04.2017 to 31.03.18.

- 17 Ophthalmic machine has been installed and working well.
- 18 8 Beds have been kept ready for emergency.
- 19 ALS contract BLS railway ambulance available.
- 20 Tender of Bio Medical Waste has finalised and BMW work is running.
- 21 Tender of Housekeeping has finalised and work is running.
- 22 Procure of Linen item in hospital.
- 23 Procure and Installation of four big & two small water purifier.
- 24 Sanitary pad dispense machine 04 no a- Hospital b- Kendriya Vidyalay c-
P Branch d- Shopping complex.
- 25 Two Sanitary Pad incinerator machine are under process.



Vigilance Department

History of Vigilance Department in MCF/RBL:

- Modern Coach Factory, Raebareli is under setting up stage and we are now taking over functions independently. There are nine departments in this organisation, i.e.: (i) Mechanical (ii) Electrical (iii) Stores (iv) Accounts (v) Personnel (vi) Civil (vii) Medical (viii) IT and S&T (ix) General Administration.
- At present against the 172 sanctioned posts in Gazetted cadre only 122 posts are in operation along with 2262 number of non-gazetted posts. Organisation chart of Vigilance Department is as follows:

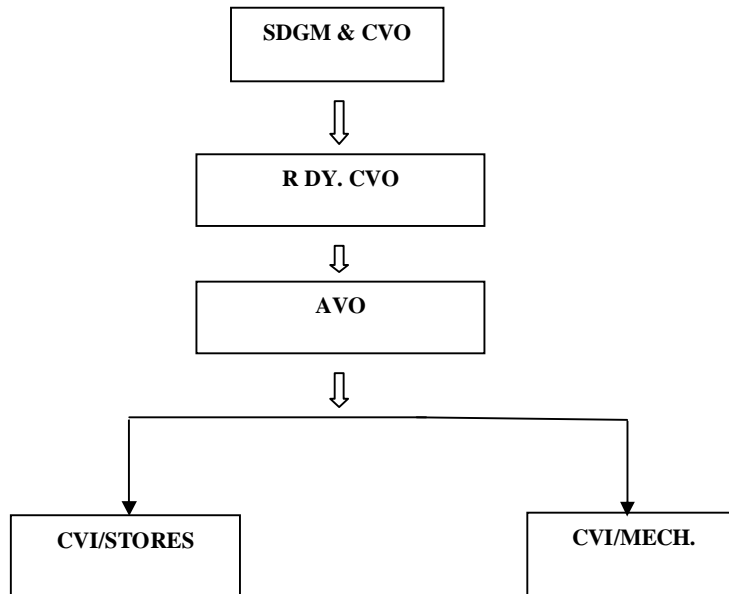

Summary of Cases:-

- In year 2017-18, 01 CVC & PIDPI complaint, 12 Railway Board referred complaints & 07 other (Direct/Other Railway referred) complaints have been received.

Achievement:-

- (i) During year 2017-18, out of 20 vigilance complaints, 16 complaints have been closed (03 closed as anonymous, 04 Closed as pseudonymous & 08 closed as no vigilance angle noticed) and 04 complaints are under investigation.
- (ii) During one of the vigilance investigation related to payment of contract labour, it has been noticed that there is some mismatch between EPF deduction & deposition by the firms. In order to minimise such

shortcomings, a set of system improvement guidelines along with checklists has been issued for better implementation of contract labour laws & minimum wages paid to contract labourers attached herewith as Annexure- 'A'.

- (iii) The Vigilance Awareness Week, 2017 was observed from 30.10.2017 to 04.11.2017. Various activities conducted during this week like Vigilance pledge in administrative building & workshops premises, pamphlets, posters and hoarding exhibiting anti-corruption themes were distributed and displayed at prominent places in admin building, workshop and township premises. Badges displaying "My Vision- Corruption Free India" were distributed among officers and staff of MCF/RBL. A customer/vendor grievance redressal camp was organised. Vigilance pledge, essay writing and poster competition on the topic "My Vision- Corruption Free India" was organized at Ganesh Inter College, Aihar & Kendriya Vidyalaya. 2nd Issue of vigilance bulletin has been released by the General Manager/MCF.





Security



**RAILWAY PROTECTION FORCE
MODERN COACH FACTORY, RAEBARELI**

Annual Report -- 2017-18



Railway Protection Force has assumed the duties of Protecting the Railway Property of the Modern Coach Factory, Raebareli since 15th February, 2011. Railway Protection Force (RPF) is an Armed Force of the Union. The Responsibility of this Unit is to protect the Railway Assets of the Modern Coach Factory, Raebareli. For this purpose, Strength of 61 members of the Force has been sanctioned.

At MCF, RPF has a set up of Executive Branch and Crime & Special Intelligence Units. A 24X7 Security Control Room has also been Operationalised. All these Units work under the control and command of Senior Security Commissioner/RPF. The Administrative Control of this Security Department lies with Inspector General-cum-CSC/RPF/Northern Railway, Baroda House, New Delhi and General Supervision is under the Principal Chief Mechanical Engineer, MCF.

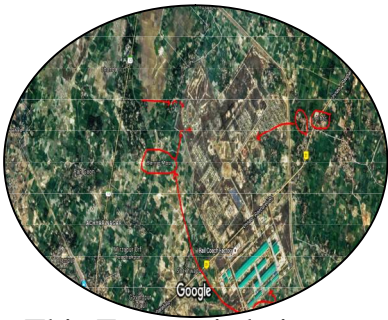

JURISDICTION

This Factory is being set up in 540 hectare land, which includes construction of a modern, Eco-Friendly Township with need based Social Infrastructure for providing Residential Accommodation to its Employees.

The Modern Coach Factory, Lalganj, Rae Bareli, is situated at 05 Km east of Lalganj Railway Station on Lalganj-Raebareli Road. The Factory Area is spread across 1.67 Sq.Km, and Township Area is spread across 353 Ha land.

The Township is encircled by a 10.57 Km Long Perimeter Boundary Wall and the length of the Perimeter boundary wall of the Workshop is 5.4 Kms. The MCF area falls under the jurisdiction of Police Station, Lalganj. The Police Station, Lalganj comes under Lucknow range which is headed by an IG, Uttar Pradesh Police.



PRIVATE SECURITY

The Railway Protection Force is being assisted by Uttar Pradesh Purva Sainik Kalyan Nigam Limited (A UP Government Undertaking), who had been awarded a Contract for a Period of 36 months from the date of actual commencement of the work.(viz; from 10.07.2016 to 09.07.2019) for Guarding the Railway Property in the indentified Non-Core Areas, having a strength of 96 Security Guards.

POSTING & TRAINING

The General tenure of Non-Gazetted RPF Personnel at MCF is for 3-5 years. The Periodical Transfer of RPF staff is carried out by the IG-cum-CSC/RPF/NR. The Members of the Force are regularly trained to update their Soft & Hard Skills.

The Present Strength for the year 2017-18 of the RPF Personnel is as under:

Description	Sr.SC	SC	IPF	SI	ASI	HC	Const	Total
Sanction Strength	01	01	02	08	09	11	31	61
Present Strength	01	01	01	07	05	--	39	52
Vacancy	-	-	01	01	04	11	+8	9

The Training details of the RPF Personnel are as under:

S. No.	Name	Ran k	Course Name	From	To
1.	Ishwar Singh	CT	Jungle Warfare	07.08.2017	02.09.2017
2.	Rajbir Singh	CT	Jungle Warfare	07.08.2017	02.09.2017
				Return Without complete (Father Death)	
3.	Nitin Kumar	CT	8 th all India Commando Competition from 15 th to 20 th January, 2018	Return Without complete (Not Selected in final Competition)	
4.	Dhanraj Dhankar	CT	Re-Orientation Training	26.03.2018	-
5.	Govinda Ram	CT			

RSMS Course

S.No.	Name Sh.	Ran k	Course	From	To
1.	Pushpendra Kumar	CT	RSMS Course	24.07.2017	28.07.2017
2.	Deopal Singh	SI		30.10.2017	03.11.2017
3.	Umesh Kr. Sharma	ASI		27.11.2017	01.12.2017
4.	Ramsanjivan Yadav	ASI		11.12.2017	15.12.2017
5.	Sunil Kumar Tiwari	CT		12.02.2018	16.02.2018
6.	R.B. Singh	ASI		12.03.2018	16.03.2018



ACCOMODATION

- Accommodation is provided to the RPF Staff in the Railway Quarters, the details of which is as under:

S.No.	Types of quarter	No of quarters	
		Available	Further requirement
01	Type-II	10	09
02	Type-III	03	03
03	Type-IV (DS)	02	
04	Type-IV (SS)	01	
05	Type-V	01	

DOG SQUAD

The Dog Kennel for 01 Tracker & 01 Sniffer Dog has been proposed for which a Dog Kennel is to be constructed. The matter is under active consideration by the Competent Authority.

RPF Barrack Complex



02 Nos new RPF barracks at the MCF Township have been constructed and operations started on 26th June, 2018. The description is as follows:

Sr. No.	Description	Capacity
1.	Shaurya Sadan (For Staff)	32 Beds
2.	Shakti Sadan (For Subordinate Officers)	10 Beds

The both Barracks have been provided with all the essential amenities hygiene and healthy living as per rooms.



CRIME CONTROL

During the year 2017-2018, the RPF was able to successfully implement the Zero Tolerance Policy as the result of which, 05 cases of theft of Railway Property was registered. This result was achieved due to 24 X 7 hours Patrolling, Strict Access Control at all the Entry/Exit Gates and round the clock Surveillance of the Identified Vulnerable Points.



ARMS & AMMUNITIONS:

This RPF unit is equipped with latest Weapons. The details of which are as under:

S. N.	Arms	Quantity	Sighting	Ammunitions	Spare Magazine	Bayonet	Nozzle Cap
1.	Rifle 7.62 mm{SLR} IAI	04 Nos.	--	400 Nos.	16 Nos.	--	--
2.	ARM 7.62x39mm ARM	03 Nos.	--	300 Nos.	12 Nos.	--	--

3.	Rifle 5.56mm{INSA S} fold Butt 2A	08 Nos.	08 Nos.	600 Nos.	40 Nos.	04 Nos.	08 Nos.
4.	Pistol Auto 9mm with Magazine	22 Nos.	--	1330 Nos.	44 Nos.	--	--
5.	Carbine Machine Gun 9mm IA. IAI	08 Nos.	--		24 Nos.	--	--
Total =		45 Nos.	08 Nos.	2630 Nos.	136 Nos.	04 Nos.	08 Nos.

MODERNISATION

- MCF/RBL/NR has become the 1st Production Unit over Indian Railways to start Aerial Surveillance with State of the Art Day/Night Ultra Advanced Cameras with Intelligent Video Analytics having features like Motion Detection Analytics through Pixel Change Detection, full Body Profiling for Facial Recognition, Crowd Density Estimations, Target Locking/Tracking, Fired Detection through Image Distortion Analysis, Suspicious Behaviour Identification etc
- To strengthen the working of the Force, the Force has been provided with latest Security Gadgets modern Bullet Proof Jackets & Helmets, Polycarbonate Shield and Canes, Dragon Search Lights, High resolution CCTV Based Surveillance System etc. the details of the Security Items are as under:

Name of the Security Item	Quantity
Bullet Proof Jacket	06 Nos.
Bullet Proof Helmet	10 Nos.
Polycarbonate Shield	20 Nos.
Body Protector	20 Nos.
Polycarbonate Lathi	20 Nos.
Sony Camcoder	01 No
Sony Dsc Camera	01 NO
Dragon Search Light	05 Nos.



ACCESS CONTROL

It is proposed to realize an IP based integrated security system for Intruder Detection, Alarm Generation and Protection. The system shall have the following features:

- Totally an IP based network, digitally controlled and remote monitoring system.
- Graphical Mimic Panel at Control Room
- IP based Access Control System for MCF/RBL is being designed and finalized.
- This System will be integrated with the n electrically controlled Boom Barriers & RFID Based identification System at the Entry/Exit Gates.

ASSISTANCE REQUIRED FROM THE RAILWAY BOARD

A Proposal for Sanctioning/Creation of additional 137 nos Non-gazetted RPF personnel for MCF/RBL with the approval of CSC/NR concurred by the Associate Finance and approved by the GM/ has been sent to the Secretary Railway Board with copy to Security Directorate, Railway Board in Feb 2016. An Early Sanction will strengthen the Security of MCF/RBL Assets

THE FUTURE ROADMAP

- Developing a State of the Art Integrated Security Architecture Comprising of Intrusion Detection System and RFID based Access Control
- Achieving Higher standard of efficient Practices as specified by the ISO



Sports Association

Annual Report 2017-18

1.0 Cricket

Sh. Vikash Chaoudhary, OS Stores department was nominated as fitness trainer for Indian Railway Cricket team for Coaching Camp from 24th to 05th October 2017 at kapurthala.

Sh. Vikash Chaoudhary , OS Storers department was nominated as fitness trainer for Indian Railway U-23 Cricket team from 08th October to 14th September 2017 at Bengal.

Inter Department tournament was conducted at MCF Cricket Stadium and won by Admin Bolck.

MCFSa organised 7 a side Intdepartmental Indoor Cricket Tournament (GM Cup) 2017-18

2.0 Lawn Tennis Team

First Time MCF team has participated in All India Railway Lawn Tennis Championship conducted by (RDSO) Lucknow.

3.0 Football

Inter departmental tournament was conducted at MCF Football Stadium and won by furnishing shop.

4.0 Hockey

MCF Hockey team was participated in Dstrict Hockey League.

Sh. Vikash Chaoudhary, OS Stores department was nominated as fitness trainer for Indian Railway Hockey team for Coaching Camp from 24th May to 14th June 2017 at Bangalore.

Sh. Vikash Chaidhary, OS Stores department was nominated as fitness trainer for Indian Railway Hockey team for Coaching Camp from 15th June to 25th June at Lucknow.

5.0 Summer Coaching Camp.

MCFSa had organised summer coaching camp at MCF during the summer vacations in following games and around 250 children between age group 04 to 18 years were participated ti to the event.

1. Hockey
2. Football
3. Cricket
4. Table Tennis
5. Badminton
6. Athleics
7. Aerobics

6.0 Bal divas khel mela

Bal divas khel mela organised by MCFSA for children age group between 02 to 12 years and around 300 children were participated.

7.0 Aquatic Team

MCF team has participated in All India Railway aquatic Championship conducted by (ER) Kolkata.

8.30 Athletics Team

MCF team has participated in Athletes all Indian Railway Championship conducted by (SR) Trichirapalli.

9.0 MCFSA has organised All India Railway Table Tennis Championship 2017-18.

65th All India Railway Table Tennis Championship 2017-18 was organised in befitting manners from 3rd to 7th July 2017 by MCF Sports Association at Gomti Indoor Stadium, Lalganj Raebareli and more than 10 teams and around 130 Sports Association & officials from different Railways were participated in this event.

5 MCFSA has organised All India Railway Kabaddi Championship 2017-18

67th (men) all India Railway kabaddi Championship 2017-18 was organised in befitting manners from 08/11/2017 to 08/11/2017 by MCF Sports Association at Gomti Indoor Stadium, Lalganj Raebareli and more than 17 teams and around 260 players & officials from different Railways were participated in this event.

6 Sports Facilities at MCF

Indoor & Outdoor sports stadium have playing facilities at MODERN Coach Factory Sports i.e. Badminton, Basketball, Squash, Table Tennis, Yoga, Taekwondo cum Marshal Art, Multigym, Hockey, Football, Cricket, Volleyball, Lawn Tennis, Golf, Weightlifting, Power lifting, Boxing, Gymnastic, Billiards, Other sports facilities may be added subsequently.

7 Recruitment

Shri Ramesh N, Cyclist has been recruited as Jr. Clerk on 28/06/2017 under Talent Scouting.

First time MCF team has participated in All India Railway Cyclist Championship conducted by (NR) and MCF has secured Bronze Medal.

13. Badminton

Inter department tournament was conducted at MCF Indoor stadium.

14. Billiards

Billiards Inter department tournament was conducted at MCF Indoor Stadium.

15. Chess

Chess Inter department tournament was conducted at MCF Indoor Stadium.

16. Cross Country

Cross Country running event was conducted at MCF.
