

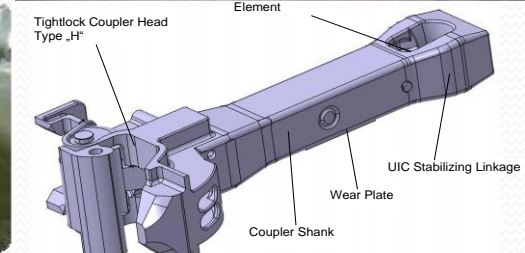

# Main Components of Modern Coaches

## SHELL ITEMS

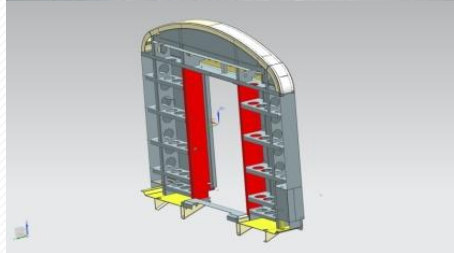
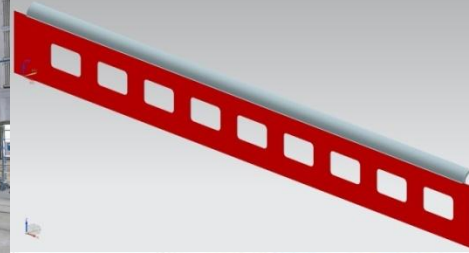

## BOGIE ITEMS

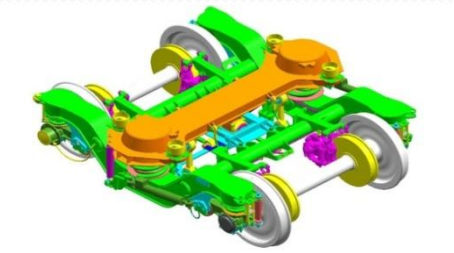

## FURNISHING ITEMS



# Small Fixed Window For L2AC Coaches

PI No (Price List No.)	33564176
Description Of The Item	Small Fixed Window For L2Ac Coaches
Unit Of Purchase	Number
Drawing & Specification Details	LW54146
Last Purchase Rates(Rs.)	5347.50
Quantity Required Per Coach	1
Quantity Required per 1000 coaches.	1000
Estimated Value of Annual Requirement (Rs. in lakhs).	60
Brief details about the item and its manufacturing :	
Material Used : Glass, Aluminium Extrusion, Rubber profile	
Brief Process: Assembly of glass, Al. extrusion, Glueing etc	



# Air Inlet Duct For Ac-2T(LHB)

PI No (Price List No.)	33593036
Description Of The Item	Air Inlet Duct For Ac-2T(LHB)
Unit Of Purchase	Numbers
Drawing & Specification Details	LW44385 ALT A
Last Purchase Rates(Rs.)	219530.00
Quantity Required Per Coach	1
Quantity Required per 1000 coaches.	1000
Estimated Value of Annual Requirement (Rs. in lakhs).	2145
Brief details about the item and its manufacturing :	
Material Used : Aluminium	
Brief Process: SHEARING, BENDING, FABRICATION	



# Set Of Ceiling Angles For Ac2T LHB Coach

PI No (Price List No.)	33595331
Description Of The Item	Set Of Ceiling Angles For Ac2T LHB Coach
Unit Of Purchase	Set
Drawing & Specification Details	AS PER MATERIAL PLANNING LIST NO MPLCEA2TEL VERSION 2.
Last Purchase Rates(Rs.)	5979.75
Quantity Required Per Coach	1
Quantity Required per 1000 coaches.	1000
Estimated Value of Annual Requirement (Rs. in lakhs).	60
Brief details about the item and its manufacturing :	
Material Used : Aluminium	
Brief Process: SHEARING, BENDING	



# Set Of Air Grills For L2AC Coaches

PI No (Price List No.)	33595380
Description Of The Item	Set Of Air Grills For L2AC Coaches
Unit Of Purchase	Set
Drawing & Specification Details	AS PER MATERIAL PLANNING LIST NO MPLAGL2AC
Last Purchase Rates(Rs.)	1890.00
Quantity Required Per Coach	1
Quantity Required per 1000 coaches.	1000
Estimated Value of Annual Requirement (Rs. in lakhs).	18
Brief details about the item and its manufacturing :	
Material Used : Aluminium	
Brief Process: SHEARING, BENDING, FABRICATION	



# Pillar Assembly

PI No (Price List No.)	33574157
Description Of The Item	Pillar Assembly
Unit Of Purchase	Numbers.
Drawing & Specification Details	LE10242 ALT 'B'
Last Purchase Rates(Rs.)	3181.50
Quantity Required Per Coach	2
Quantity Required per 1000 coaches.	2000
Estimated Value of Annual Requirement (Rs. in lakhs).	68
Brief details about the item and its manufacturing :	
Material Used : Stainless steel 409M	
Brief Process: PRESS WORK AND FABRICATION	



# Edpm Rubber Packing For Floor L=2000Mm

PI No (Price List No.)	33593735
Description Of The Item	EDPM Rubber Packing For Floor L=2000Mm
Unit Of Purchase	Numbers.
Drawing & Specification Details	LW41101 ALT B
Last Purchase Rates(Rs.)	318.15
Quantity Required Per Coach	50
Quantity Required per 1000 coaches.	50000
Estimated Value of Annual Requirement (Rs. in lakhs).	193
Brief details about the item and its manufacturing :	
Material Used : EDPM RUBBER	
Brief Process: RUBBER EXTRUSION	



# Set Of Side Wall Panels

<b>PI No (Price List No.)</b>	<b>33595197</b>
<b>Description Of The Item</b>	<b>Set of Side Wall Panels For AC2T Eog LHB (Mdts133 Rev.04,Mdts118 Rev01 &amp; L.No.Md46271 Dt.12-11/2003) Traceability Mark As Per Design Letter No.Md462131 Dt.05-06/2006</b>
<b>Unit Of Purchase</b>	<b>Set</b>
<b>Drawing &amp; Specification Details</b>	<b>AS PER MATERIAL PLANNING LIST NO MPLSWP2TEL VERSION 16</b>
<b>Last Purchase Rates(Rs.)</b>	<b>118000.96</b>
<b>Quantity Required Per Coach</b>	<b>1</b>
<b>Quantity Required per 1000 coaches.</b>	<b>1000</b>
<b>Estimated Value of Annual Requirement (Rs. in lakhs).</b>	<b>1161</b>
<b>Brief details about the item and its manufacturing :</b>	
<b>Material Used : FRP</b>	
<b>Brief Process: Hand lay up</b>	



# Non Ac Area Ceiling Arrgt.

PI No (Price List No.)	33596736
Description Of The Item	Non Ac Area Ceiling Arrgt. For LHB Coaches.Industrial Lock To Drgno.Lw44158 Alt 'A'/Lw44318 Alt 'A' .
Unit Of Purchase	Numbers.
Drawing & Specification Details	LW44452 ALT B ADHESIVE U BOND 301 TO BE USED WHERE EVER ADHESIVE APPEARS IN THE DRAWING AND AS PER CONDITION LIST NO.MP/FUR/COND/03.
Last Purchase Rates(Rs.)	91499.10
Quantity Required Per Coach	1
Quantity Required per 1000 coaches.	1000
Estimated Value of Annual Requirement (Rs. in lakhs).	646

Brief details about the item and its manufacturing :

Material Used : SS, wood, Phenolic Foam & industrial loack

Brief Process: Carpentry Work & Fabrication



# END WALL DOOR COMPLETE

PI No (Price List No.)	33565624
Description Of The Item	End Wall Door Complete
Unit Of Purchase	Numbers.
Drawing & Specification Details	LW56350 ALT C
Last Purchase Rates(Rs.)	54600.00
Quantity Required Per Coach	2
Quantity Required per 1000 coaches.	2000
Estimated Value of Annual Requirement (Rs. in lakhs).	1060
Brief details about the item and its manufacturing :	
Material Used: RDSO. SPEC: C-K:201 (X5CrNi1810 AISI:304), Aluminium frame IS:733-83 63400 W,RDSO/Spec C-8401,IS:3075-1986 PART-3,bearing SKF No. 6000-2Z, IS:13204-1991	
Brief Process: Sheet Cutting in plasma profile cutting machine, and part assembled	



# SS LUGGAGE RACK

<b>PI No (Price List No.)</b>	<b>33594004</b>
<b>Description Of The Item</b>	<b>SS Luggage Rack</b>
<b>Unit Of Purchase</b>	<b>Numbers.</b>
<b>Drawing &amp; Specification Details</b>	<b>LA62102 ALT -D</b>
<b>Last Purchase Rates(Rs.)</b>	<b>487.59</b>
<b>Quantity Required Per Coach</b>	<b>9</b>
<b>Quantity Required per 1000 coaches.</b>	<b>9000</b>
<b>Estimated Value of Annual Requirement (Rs. in lakhs).</b>	<b>30</b>
<b>Brief details about the item and its manufacturing :</b>	
<b>Material Used : Stainless Steel (AISI:304)</b>	
<b>Brief Process: Bending followed by welding</b>	



# Wear Plate

PL No (Price List No.)	33501520
Description Of The Item	Wear Plate
Unit Of Purchase	Numbers
Drawing & Specification Details	1268698 VER. 00 AND SPECIFICATION NO. Mn12;UIC 893-0,IRS:R65-78 Gr.1
Last Purchase Rates (Rs.)	100.80
Quantity Required Per Coach	4
Quantity Required per 1000 Coaches.	4000
Estimated Value of Annual Requirement (Rs. in lakhs)	4
Brief details about the item and its manufacturing :	
Material Used : Austenitic Manganese Steel Grade I to IS:276-1969.	
Brief Process: Forging and Rolling	



# Security Plate

<b>PL No (Price List No.)</b>	<b>33500320</b>
<b>Description Of The Item</b>	<b>Security Plate</b>
<b>Unit Of Purchase</b>	<b>Numbers</b>
<b>Drawing &amp; Specification Details</b>	<b>1356176 VER. 07 AND SPEC NO. C-K201,X5CrNi18-10(304)2D/2B</b>
<b>Last Purchase Rates (Rs.)</b>	<b>23.10</b>
<b>Quantity Required Per Coach</b>	<b>8</b>
<b>Quantity Required per 1000 coaches</b>	<b>8000</b>
<b>Estimated Value of Annual Requirement (Rs. in lakhs)</b>	<b>1.85</b>

**Brief details about the item and its manufacturing :**

**Material Used : Steel Grade as per C-K201**

**Brief Process: CUTTING, BENDING, FABRICATION**



# Fixation Ball Joint

PL No (Price List No.)	33509414
Description Of The Item	Fixation Ball Joint
Unit Of Purchase	Numbers
Drawing & Specification Details	1227331 VER. 06 & EN 1.0570;10025/29;MDTS 166 REV. 02
Last Purchase Rates(Rs.)	205.80
Quantity Required Per Coach	16
Quantity Required per 1000 Coaches	16000
Estimated Value of Annual Requirement (Rs. in lakhs)	33
Brief details about the item and its manufacturing :	
Material Used : DIN EN 10025/29	
Brief Process: Forging	



# Spring Guide Upper

<b>PL No (Price List No.)</b>	<b>33509530</b>
<b>Description of The Item</b>	<b>Spring Guide Upper</b>
<b>Unit Of Purchase</b>	<b>Numbers</b>
<b>Drawing &amp; Specification Details</b>	<b>1254690 VER. 03R</b>
<b>Last Purchase Rates(Rs.)</b>	<b>155.57</b>
<b>Quantity Required Per Coach</b>	<b>8</b>
<b>Quantity Required per 1000 coaches.</b>	<b>8000</b>
<b>Estimated Value of Annual Requirement (Rs. in lakhs).</b>	<b>12.50</b>
<b>Brief details about the item and its manufacturing :</b>	
<b>Material Used : DIN EN 10025/29</b>	
<b>Brief Process: Forging, Welding ,Machining</b>	



# Bracket for Lateral Damper

PL No (Price List No.)	33500782
Description Of The Item	Bracket for Lateral Damper
Unit Of Purchase	Numbers
Drawing & Specification Details	LW05116 ALT. 'Nil'
Last Purchase Rates(Rs.)	378.00
Quantity Required Per Coach	2
Quantity Required per 1000 coaches	2000
Estimated Value of Annual Requirement (Rs. in lakhs)	7.56
Brief details about the item and its manufacturing :	
Material Used : DIN EN 10025/29	
Brief Process: Forging and Machining	



# Sleeve

<b>PL No (Price List No.)</b>	<b>33500435</b>
<b>Description Of The Item</b>	<b>Sleeve</b>
<b>Unit Of Purchase</b>	<b>Numbers</b>
<b>Drawing &amp; Specification Details</b>	<b>LW03187 ALT.'NIL</b>
<b>Last Purchase Rates(Rs.)</b>	<b>128.80</b>
<b>Quantity Required Per Coach</b>	<b>8</b>
<b>Quantity Required per 1000 coaches</b>	<b>8000</b>
<b>Estimated Value of Annual Requirement (Rs. in lakhs)</b>	<b>10.30</b>
<b>Brief details about the item and its manufacturing :</b>	
<b>Material Used : DIN EN 10025/29</b>	
<b>Brief Process: CASTING and Machining</b>	



# Rubber Spring Centering

PL No (Price List No.)	33500411
Description Of The Item	Rubber Spring Centering
Unit Of Purchase	Numbers
Drawing & Specification Details	1267577 VER. 00 AND SPECIFICATION NO.IS:1875-92 CLASS 1A,MDTS 166 REV. 02
Last Purchase Rates(Rs.)	599.55
Quantity Required Per Coach	4
Quantity Required per 1000 coaches	4000
Estimated Value of Annual Requirement (Rs. in lakhs)	23.98
Brief details about the item and its manufacturing :	
Material Used : Steel EN- GJS-400-15	
Brief Process: Casting, Surface protection	



# Axle End Cover

PL No (Price List No.)	33500289
Description Of The Item	Axle End Cover.
Unit Of Purchase	Numbers
Drawing & Specification Details	1268835 VER. 01 & SPECIFICATION NO. 17.334 100 06/110 01,SG 400/15 IS:1865, MDTS 166 REV. 02
Last Purchase Rates (Rs.)	586.88
Quantity Required Per Coach	2
Quantity Required per 1000 coaches	2000
Estimated Value of Annual Requirement (Rs. in lakhs)	11.73
Brief details about the item and its manufacturing :	
Material Used : Steel EN- GJS-400-15	
Brief Process: Casting, Surface protection	



# Dome Cum Air Reservoir Assly (LH)

PL No (Price List No.)	3302204
Description Of The Item	Dome Cum Air Reservoir Assly (LH)
Unit Of Purchase	Numbers
Drawing & Specification Details	LW04140 ALT.'b'
Last Purchase Rates(Rs.)	17754.45
Quantity Required Per Coach	2
Quantity Required per 1000 coaches	2000
Estimated Value of Annual Requirement (Rs. in lakhs)	355.09
Brief details about the item and its manufacturing :	
Material Used : DIN EN 10025/29	
Brief Process: Cutting, Rolling, Welding and Machining	



# Cross Section

<b>PL No (Price List No.)</b>	<b>33502006</b>
<b>Description Of The Item</b>	<b>Cross Section</b>
<b>Unit Of Purchase</b>	<b>Numbers</b>
<b>Drawing &amp; Specification Details</b>	<b>1267405 VER. 02 AND MDTS 150 REV. NIL &amp; MDTS 166 REV. 2</b>
<b>Last Purchase Rates(Rs.)</b>	<b>9505.84</b>
<b>Quantity Required Per Coach</b>	<b>2</b>
<b>Quantity Required per 1000 coaches</b>	<b>2000</b>
<b>Estimated Value of Annual Requirement (Rs. in lakhs)</b>	<b>190.11</b>
<b>Brief details about the item and its manufacturing :</b>	
<b>Material Used : EN 10025/29</b>	
<b>Brief Process: Cutting, Milling, Welding and Machining</b>	



# Roof Mounted AC Package unit

PL No. (Price List No.)	33635225 & 33635237
Description of the Item	Roof Munted AC Package unit
Unit of Purchase	Set
Drawing & Specification Details	Drg.No. RMPU Spec No. RDSO/PE/SPEC/AC 0061-2005(REV-I), &Drg.No. RDSO/PE/SPEC/AC/0061-2005 (REV-1), TYPE-1 & Microprocessor to RDSO/PE/SPEC/AC/0139-2009(REV-1), RDSO Specification No.RDSO/PE/SPEC/AC/0061-2005 (REV-1) and Microprocessor Controller Unit -01 No. to the RDSO Spec. No. RDSO/PE/SPEC/AC/0139-2009(Rev.1),
Last Purchase Rates (Rs.)	P.O.No. <a href="#">31051900100856</a> dt.22/07/19 on M/s.AMIT ENGINEERS-BADDI ( Reg } Rs. 884467.92 & P.O.No.31051900100857 dt.22/07/19 on M/s.ESS ESS KAY ENGG CO. (P) LTD.-KAPURTHALA ( Reg } Rs. 1615420.76
Quantity Required Per Coach	1
Quantity Required 2021-22 Coaches	603
Estimated Value of Annual Requirement (Rs.)	97,40,98,718.28



# ZS Coupling

PL No. (Price List No.)	33641304
Description of the Item	ZS Coupling
Unit of Purchase	Set
Drawing & Specification Details	Drg. No. RDSO/PE/SPEC/AC/0177 (Rev. 0 )- 2013 COR-1 WITH RCF ANNEXURE-B OR LATEST, Spec: RDSO/PE/SPEC/AC/0177 (Rev. 0 )- 2013 COR-1 WITH RCF ANNEXURE-B OR LATEST
Last Purchase Rates (Rs.)	P.O.No. <a href="#">05190309102106</a> dt.15/11/19 on M/s. PRIME ELECTRONICS-SONIPAT ( Reg } Rs. 239845.62
Quantity Required Per Coach	1
Quantity Required 2021-22 Coaches	603
Estimated Value of Annual Requirement (Rs)	14,46,26,908.86



# Tail light

<b>PL No. (Price List No.)</b>	<b>33641614</b>
<b>Description of the Item</b>	<b>Tail light</b>
<b>Unit of Purchase</b>	<b>Numbers</b>
<b>Drawing &amp; Specification Details</b>	<b>DRG. No. LP-73200,ALT-C as per Drg.No. EDTS-215,AM-1 OR Latest, EDTS-215,AM-1 OR Latest Spec:EDTS-215,AM-1 OR Latest</b>
<b>Last Purchase Rates (Rs.)</b>	<b>P.O.No.05490039101976 dt.01/11/19 on M/s.D R AUTO INDUSTRIES-NOIDA ( Reg } Rs. 17080.00</b>
<b>Quantity Required Per Coach</b>	<b>1</b>
<b>Quantity Required 2021-22 Coaches</b>	<b>130</b>
<b>Estimated Value of Annual Requirement (Rs.)</b>	<b>22,20,400</b>



# PA System

<b>PL No. (Price List No.)</b>	<b>33640993</b>
<b>Description of the Item</b>	<b>PA System</b>
<b>Unit of Purchase</b>	<b>Set</b>
<b>Drawing &amp; Specification Details</b>	<b>Drg.No. EDTS173, REV-B, COR.-1,TYPE-III or Latest, Spec:EDTS173, REV-B, COR.-1,TYPE-III or Latest</b>
<b>Last Purchase Rates (Rs.)</b>	<b>P.O.No.05201050101503 dt.07/11/20 on M/s.PROZONE-JALANDHAR ( Reg } Rs. 43693.23</b>
<b>Quantity Required Per Coach</b>	<b>1</b>
<b>Quantity Required 2021-22 Coaches</b>	<b>527</b>
<b>Estimated Value of Annual Requirement (Rs.)</b>	<b>2,30,26,332.21</b>



# 9KVA Trasformer

<b>PL No. (Price List No.)</b>	<b>33635043</b>
<b>Description of the Item</b>	<b>9KVA Trasformer</b>
<b>Unit of Purchase</b>	<b>Set</b>
<b>Drawing &amp; Specification Details</b>	<b>Drg. No. RDSO/PE/SPEC/TL/0158-2010,REV-0,TYPE-1 or latest, Spec: RDSO/PE/SPEC/TL/0158-2010,REV-0,TYPE-1 or latest</b>
<b>Last Purchase Rates (Rs.)</b>	<b>P.O.No.05190287100709 dt.22/05/20 on M/s.VIMAL TRANSFORMER CORPORATION- MORADABAD ( Reg } Rs. 98700.00</b>
<b>Quantity Required Per Coach</b>	<b>1</b>
<b>Quantity Required 2021-22 Coaches</b>	<b>566</b>
<b>Estimated Value of Annual Requirement (Rs.)</b>	<b>5,58,64,200</b>



# 15 KVA Trasformer

<b>PL No. (Price List No.)</b>	<b>33635250</b>
<b>Description of the Item</b>	<b>15 KVA Trasformer</b>
<b>Unit of Purchase</b>	<b>Numbers</b>
<b>Drawing &amp; Specification Details</b>	<b>Drg.No. RDSO/PE/SPEC/TL/0158-2010(REV-0) TYPE-II OR LATEST, Spec:RDSO/PE/SPEC/TL/0158-2010(REV-0) TYPE-II OR LATEST</b>
<b>Last Purchase Rates (Rs.)</b>	<b>P.O.No.05190287100709 dt.22/05/20 on M/s.VIMAL TRANSFORMER CORPORATION-MORADABAD ( Reg } Rs. 108342.15</b>
<b>Quantity Required Per Coach</b>	<b>1</b>
<b>Quantity Required 2021-22 Coaches</b>	<b>104</b>
<b>Estimated Value of Annual Requirement (Rs.)</b>	<b>1,12,67,583.6</b>



# CENTRE BUFFER COUPLER

<b>PI No (Price List No.)</b>	<b>33554511</b>
<b>Description Of The Item</b>	<b>HIGH TENSILE TIGHTLOCK CENTRE BUFFER COUPLER</b>
<b>Unit Of Purchase</b>	<b>Sets</b>
<b>Drawing &amp; Specification Details</b>	<b>RDSO/2011/CG-03 Rev.-01 with amendment slip no. 1 of November 2016</b>
<b>Last Purchase Rates(Rs.)</b>	<b>188895</b>
<b>Quantity Required Per Coach</b>	<b>2</b>
<b>Quantity Required per 1000 coaches.</b>	<b>2000</b>
<b>Estimated Value of Annual Requirement (Rs. in lakhs).</b>	<b>3778</b>
<b>Brief details about the item and its manufacturing :</b>	
<b>Material Used : M - 201 Grade E Steel</b>	
<b>Brief Process: Casting, Forging &amp; machining Procurement from OEMs only</b>	



# End Wall Construction Assly.

PI No (Price List No.)	33555448
Description Of The Item	End Wall Construction Assly
Unit Of Purchase	Numbers.
Drawing & Specification Details	MP09RBACCW VER-1,1 10113.0.20.120.001 ALT 'G'
Last Purchase Rates(Rs.)	165058.31
Quantity Required Per Coach	2
Quantity Required per 1000 coaches.	2000
Estimated Value of Annual Requirement (Rs. in lakhs).	3301
Brief details about the item and its manufacturing :	
Material Used : Stainless steel sheet to RDSO Spec CK201, X2CrNi12	
Brief Process: Fabrication work involving component cutting on Laser profile machines, bending, pressing, followed by Mig/Mag welding.	



# Pillar

PI No (Price List No.)	33570784
Description Of The Item	Pillar
Unit Of Purchase	Numbers.
Drawing & Specification Details	2 10113.1.20.112.121
Last Purchase Rates(Rs.)	693
Quantity Required Per Coach	4
Quantity Required per 1000 coaches.	4000
Estimated Value of Annual Requirement (Rs. in lakhs).	27.7
Brief details about the item and its manufacturing :	
Material Used : Stainless Steel 409M	
Brief Process: PRESS WORK, FABRICATION	



# Horizontal Member

PI No (Price List No.)	33690030
Description Of The Item	Horizontal Member
Unit Of Purchase	Numbers.
Drawing & Specification Details	2 10113.1.20.113.155 A
Last Purchase Rates(Rs.)	281.16
Quantity Required Per Coach	2
Quantity Required per 1000 coaches.	2000
Estimated Value of Annual Requirement (Rs. in lakhs).	6
Brief details about the item and its manufacturing :	
Material Used : Stainless Steel 409M	
Brief Process: PROFILE CUT, PRESS WORK, FABRICATION	



# Cross Member

<b>PI No (Price List No.)</b>	<b>33554481</b>
<b>Description Of The Item</b>	<b>Cross Member</b>
<b>Unit Of Purchase</b>	<b>Numbers.</b>
<b>Drawing &amp; Specification Details</b>	<b>2 10113.0.03.100.130 ALT 'AR'</b>
<b>Last Purchase Rates(Rs.)</b>	<b>1508</b>
<b>Quantity Required Per Coach</b>	<b>2</b>
<b>Quantity Required per 1000 coaches.</b>	<b>2000</b>
<b>Estimated Value of Annual Requirement (Rs. in lakhs).</b>	<b>30.2</b>
<b>Brief details about the item and its manufacturing :</b>	
<b>Material Used : Corten Steel IRSM -41</b>	
<b>Brief Process: PROFILE CUTTING, BENDING</b>	



# Rib

<b>PI No (Price List No.)</b>	<b>33550062</b>
<b>Description Of The Item</b>	<b>Rib</b>
<b>Unit Of Purchase</b>	<b>Numbers.</b>
<b>Drawing &amp; Specification Details</b>	<b>3 10113.1.03.100.189</b>
<b>Last Purchase Rates(Rs.)</b>	<b>122</b>
<b>Quantity Required Per Coach</b>	<b>8</b>
<b>Quantity Required per 1000 coaches.</b>	<b>8000</b>
<b>Estimated Value of Annual Requirement (Rs. in lakhs).</b>	<b>9.8</b>
<b>Brief details about the item and its manufacturing :</b>	
<b>Material Used : CORTEN STEEL</b>	
<b>Brief Process: PRESS WORK</b>	



# SET OF HORIZONTAL MEMBER

<b>PI No (Price List No.)</b>	<b>33555771</b>
<b>Description Of The Item</b>	<b>Set Of Horizontal Member For LHB Ac 2 Tier Coaches</b>
<b>Unit Of Purchase</b>	<b>Set</b>
<b>Drawing &amp; Specification Details</b>	<b>SET of HORIZONTAL MEMBER LW14231</b>
<b>Last Purchase Rates(Rs.)</b>	<b>32180</b>
<b>Quantity Required Per Coach</b>	<b>1</b>
<b>Quantity Required per 1000 coaches.</b>	<b>1000</b>
<b>Estimated Value of Annual Requirement (Rs. in lakhs).</b>	<b>323</b>
<b>Brief details about the item and its manufacturing :</b>	
<b>Material Used : Stainless steel sheet 2.5mm thick to RDSO spec CK201 X2CrNi12</b>	
<b>Brief Process: Profile cut followed by bending</b>	



# SET OF ROOF FLANGE

PI No (Price List No.)	33557081
Description Of The Item	Set Of Roof Flange For Lhb Ac 2 Tier Coaches
Unit Of Purchase	Set
Drawing & Specification Details	SET CONSIST OF:1. ROOF FLANGE LW14222 ITEM 1 &7 (01 NO.)2. ROOF FLANGE LW14223 ALT A ITEM 1 & 7 (01 NOS.)
Last Purchase Rates(Rs.)	5960
Quantity Required Per Coach	1
Quantity Required per 1000 coaches.	1000
Estimated Value of Annual Requirement (Rs. in lakhs).	59.6
Brief details about the item and its manufacturing :	
Material Used : Stainless steel sheet 4mm thick to RDSO spec CK201 X2CrNi12	
Brief Process: : Profile cut followed chamfering and bending	



# DOOR CUT OUT

PI No (Price List No.)	33565247
Description Of The Item	Door Cut Out
Unit Of Purchase	Set
Drawing & Specification Details	MPDOCULHB VER-4. SET CONSIST OF:1.DOOR CUT OUT COMPLETE TO DRAWING NO. LP10112 ALT 'F (0'2 NOS.),2.DOOR CUT OUT COMPLETE TO DRAWING NO. LP10113 ALT'F (02 NOS.)
Last Purchase Rates(Rs.)	34335
Quantity Required Per Coach	1
Quantity Required per 1000 coaches.	1000
Estimated Value of Annual Requirement (Rs. in lakhs).	343

**Brief details about the item and its manufacturing :**

**Material Used :** Stainless Steel sheets to RDSO spec C-K201, X2CrNi12 and X5CrNi1810

**Brief Process:** Fabrication work involving Laser profile cutting, pressing followed by MIG/MAG welding on Fixture



# CROSS MEMBER

PI No (Price List No.)	33553890
Description Of The Item	Cross Member
Unit Of Purchase	Numbers.
Drawing & Specification Details	1 10113.1.03.100.179
Last Purchase Rates(Rs.)	1620
Quantity Required Per Coach	7
Quantity Required per 1000 coaches.	7000
Estimated Value of Annual Requirement (Rs. in lakhs).	113
Brief details about the item and its manufacturing :	
Material Used : Corten steel 4mm thick to IRSM41-97	
Brief Process: Profile cut followed by bending	

